



Agenda
Parks and Recreation Board Regular Meeting
Tuesday, December 2, 2025 - 6:30 PM
851 S. Eton, Birmingham MI
DPS Conference Room

- I. Call to order**
- II. Roll Call**
- III. Announcements, Introductions of Guests & Chairpersons Comments**
- IV. Open To The Public for Items Not On the Agenda (two minutes per person)**
- V. Approval of the minutes from previous meeting**
 - 1. October 28, 2025 Parks and Recreation Board Minutes
- VI. Unfinished Business**
- VII. New Business**

Written and submitted by 5pm Monday at the Birmingham Ice Sports Arena, one week prior to the meeting.

 - 1. Pembroke Park Playground Design Planning Session
- VIII. Miscellaneous Communications**
 - 1. Carpenter Lake Nature Preserve, Southfield, Michigan
 - 2. Student Leadership Pembroke Elementary School Communication
- IX. Reports From Staff**
 - 1. City-wide Playground Project Update
 - 2. Playgrounds Closing During Freezing Temperatures
- X. Items for Next Meeting on**

City boards and committees meet in person, and most have a virtual option available to the public. Members of the public may attend the Parks and Recreation meeting in person at Birmingham City Hall or attend virtually.

Link to Access Virtual Meeting: <https://zoom.us/j/655079760>

Telephone Meeting Access: 877 853 5247 US Toll-free

Meeting ID Code: **Meeting ID: 655 079 760**

City Hall is open to the public during regular business hours, Monday through Friday from 8 a.m. – 5 p.m. The Police Department lobby entrance on the east side of City Hall on Pierce Street operates as the after-hours public entrance.

Individuals requiring assistance to enter the building should request aid via the intercom system at the parking lot entrance gate on Henrietta Street.

Persons who require mobility, visual, hearing, or other assistance for effective participation in this public meeting should contact the City Clerk's Office at (248) 530-1880, or (248) 644-3405 (TDD) at least one day before the meeting to request help.

Las personas con incapacidad que requieren algún tipo de ayuda para la participación en esta sesión pública deben ponerse en contacto con la oficina del escribano de la ciudad en el número (248) 530-1800 o al (248) 644-3405 (para las personas con incapacidad auditiva) por lo menos un día antes de la reunión para solicitar ayuda a la movilidad, visual, auditiva, o de otras asistencias. (Title VI of the Civil Rights Act of 1964)

PARKS & RECREATION BOARD MISSION STATEMENT

The Parks and Recreation Board strives to provide opportunities for the enjoyment, education, and inspiration for present and future generations of residents and visitors through stewardship of natural, cultural and recreational resources. By continuously elevating the beauty and quality of the parks and recreation system of Birmingham, the Parks and Recreation Board will promote health and wellbeing, and strengthen the community.

You may also present your written statement to: City of Birmingham, Parks and Recreation Board 851 South Eton, Birmingham, Michigan 48009 prior to the meeting.

City of Birmingham
Parks And Recreation Board Meeting Minutes
October 28, 2025, 6:30 p.m.
851 South Eton - Conference Room

I. Call To Order

The meeting was called to order at 6:30 p.m.

II. Roll Call

Present: Chair Heather Carmona, Vice Chair Pam Graham; Board Members Susan Collins, Jessica Einstein, Sarah Kupczyk, Anne Lipp; Alternate Board Member Joseph Wrobel (arrived 6:32 p.m.); Student Board Member Abigail Murphy

Absent: Board Member Steve Sweeney; Alternate Board Member Narlu Castellano; Student Board Member Jack Bassett

Staff: Department of Public Services Director Zielinski; Parks and Recreation Manager Laird, Parks and Recreation Foreman McNab, Ice Arena and Facilities Superintendent Folk, and Recreation Coordinator Kirkwood

III. Announcements, Introductions Of Guests & Chairperson Comments

VC Graham noted the SCC had not resumed meeting and thanked staff for organizing the Pumpkin Patch event.

IV. Open To The Public For Items Not On The Agenda

V. Approval Of The Minutes – September 9, 2025

Motion by Wrobel

Seconded by Einstein to approve the minutes of our September 9th meeting.

Motion carried, 7-0.

ROLL CALL VOTE

Yeas: Wrobel, Carmona, Kupczyk, Einstein, Collins, Graham, Lipp

Nays: None

VI. Unfinished Business

1. Michigan Natural Resources Trust Fund Grant Acceptance Resolution

The Chair and PRM Laird summarized the item.

2. West Lincoln Well and Pumphouse Park Playground Update

PRF McNab presented the item. Staff answered informational questions.

Board members raised the following points during discussion:

- It looks more like a park, the staff work is appreciated, the colors are inviting, and residents are excited about the changes.

3. Poppleton Park Playground Improvements Update

PRM Laird and DPSD Zielinski presented the item. Staff answered informational questions.

Board members raised the following points during discussion:

- Feedback from children in the community on the plans has been positive and enthusiastic.
- The downtown area has parallel parking spots with a generous buffer between spots. Those are likely not as necessary in this context.
- Some accessible vehicles have rear loading options instead of side loading options.
- Option B seems to best align with the Board's consensus. Parallel spots make sense because it preserves existing trees and has the least impact on the park.
- Allowing regular on-street parking for the majority of the parking would be sufficient and save on costs as opposed to delineating specific spots. Adding more access points to the park in this case would be useful to families arriving with strollers, wagons, or other wheeled items.
- The majority of people visiting the park are local and will be able to use multi-modal transit to visit the park.
- Having a higher number of accessible parking spots makes sense since the accessibility of the park will be an attraction.
- Having more sports leagues or intergenerational recreational activities could help address residents' concerns about recreational opportunities across the lifespan.
- The playground is a portion of a 17-acre park, which leaves a lot of space for intergenerational use.
- The Board has done a pretty good job of accommodating a wide variety of needs in these designs. The Board should clarify its bare-minimum expectations in order to best support this range of needs.
- The Board is interested in exploring options in the future for adding fitness equipment areas to Poppleton.
- A brainstorming session on programming could be held in the future.

Public Comment

Danny Seidman supported adding more exercise opportunities to the park for people across the lifespan and various levels of challenge, approving Option B north of the crosswalk, locating accessible parking closest to the park, and adding more access points.

Bella Fichtenberg supported adding more exercise opportunities to the park for people across the lifespan and limiting the amount of additional parking offered.

Motion by Lipp

Seconded by Kupczyk to approve the updated draft concept plan and playground layout for the Poppleton Park Playground Improvement Project as presented, and to forward to the City Commission for their consideration and final approval, AND, to recommend the parallel parking option along Oxford Street, option B as laid out in our packet, incorporating five ADA parking spots and prioritizing the additional access spots for strollers.

Board members made the following comments on the motion:

- It was a great motion.
- This adds important accessible parking while limiting the impact on the park.

Motion carried, 7-0.

ROLL CALL VOTE

Yeas: Wrobel, Carmona, Kupczyk, Einstein, Collins, Graham, Lipp

Nays: None

VII. New Business

1. Park Rules and Regulations

PRM Laird and DPSD Zielinski presented the item. Staff answered informational questions.

Board members raised the following points during discussion:

- Children wearing helmets on e-bikes and scooters is an important way of reducing the likelihood of brain injuries.
- Some content and grammatical issues make it appropriate for this to be reviewed by staff and the City Attorney before publication.
- It is likely outside of the Parks and Recreation Board’s remit to explore offering permits for photography drones.
- The meaning of ‘dog park user’ should be clarified. The process if a dog attacks a person within a dog park should be clarified. The policies should clarify if, in the case of one dog being the clear aggressor, all involved dogs must be evaluated.
- Since tennis lessons are permitted, pickleball lessons should be permitted with the same requirements.
- The two internal discussion paragraphs regarding tennis and pickleball should not be included in the final rules.

Public Comment

Tom Boltik supported including residents living near the pickleball courts in all surveys, and only allowing Birmingham residents to use the pickleball courts.

Ava Boltik supported adding signage that emphasizes that Crestview is a neighborhood park and considering how residential neighbors are impacted by pickleball courts.

Tracy Boltik commented regarding the sounds of living close to the pickleball courts at Crestview and the parking congestion stemming from the pickleball courts, and supported more of a neighborhood focus for Crestview Park.

Motion by Einstein

Seconded by Lipp to table.

Motion carried, 7-0.

VOICE VOTE

Yeas: Wrobel, Carmona, Kupczyk, Einstein, Collins, Graham, Lipp

Nays: None

VIII. Miscellaneous Communications

1. All Communications received - Poppleton Park Playground Improvements

IX. Reports from Staff

X. Items For Next Meeting

- 1. Poppleton Park Playground Communication**
- 2. Pickleball Communications**

XI. Adjournment

The meeting was adjourned at 8:13 p.m.

A handwritten signature in black ink, appearing to read 'Laura Eichenhorn', with a long horizontal flourish extending to the right.

Connie Folk, Ice Arena and Facilities Superintendent

Laura Eichenhorn, City Transcriptionist

HELP
Design
PLAYGROUND IMPROVEMENTS
AT PEMBROKE PARK

Pembroke Park

Park Hours
6:00am to
10:00pm

Playground
Tennis
Ball Diamond
Basketball



To Report a Concern Contact:
Dept. of Public Services
248.330.1700
Hours: 8am - 5pm
248.330.1870

Dogs Allowed
on leash
Please pick up after your pet

Use of the facility is at your own risk
For a complete list of Park Rules and
Regulations please visit www.bhamgov.org

NO Alcoholic Beverages Allowed

HELP *Design* PLAYGROUND IMPROVEMENTS AT PEMBROKE PARK



City of Birmingham
151 Martin Street
P.O. Box 3001
Birmingham, MI 48012-3001

What
Pembroke Park Public Input Session

When
Tuesday, Dec. 2, 2025 6:30 p.m.

Where
851 S. Eton, Dept. of Public Services
conference room



A new playground is coming to Pembroke Park as part of citywide playground improvements, thanks to the voter-approved 2020 Parks and Recreation Bond. We invite the community to share ideas and feedback to help guide design improvements in person on Dec. 2 or online at engage.bhamgov.org. **We want to hear from you!**

Concept 1



Playground

2-12

2-12

5-12

5-12

5-12

From
100 ft (30 m)
Max. Fall Height: 20 ft (6 m)



The play components identified on this plan are IPEMA certified. (Unless model number is preceded with *) The use and layout of these components conform to the requirements of ASTM F1487. To verify product certification, visit www.ipema.org

THIS PLAY AREA & PLAY EQUIPMENT IS DESIGNED FOR AGES 2-12 YEARS UNLESS OTHERWISE NOTED ON PLAN.

IT IS THE MANUFACTURERS OPINION THAT THIS PLAY AREA DOES CONFORM TO THE A.D.A. ACCESSIBILITY STANDARDS, ASSUMING AN ACCESSIBLE PROTECTIVE SURFACING IS PROVIDED, AS INDICATED, OR WITHIN THE ENTIRE USE ZONE.

THIS CONCEPTUAL PLAN WAS BASED ON INFORMATION AVAILABLE TO US. PRIOR TO CONSTRUCTION, DETAILED SITE INFORMATION INCLUDING SITE DIMENSIONS, TOPOGRAPHY EXISTING UTILITIES, SOIL CONDITIONS, AND DRAINAGE SOLUTIONS SHOULD BE OBTAINED, EVALUATED, & UTILIZED IN THE FINAL DESIGN. PLEASE VERIFY ALL DIMENSIONS OF PLAY AREA, SIZE, ORIENTATION, AND LOCATION OF ALL EXISTING UTILITIES, EQUIPMENT, AND SITE FURNISHINGS PRIOR TO ORDERING. SLIDES SHOULD NOT FACE THE HOT AFTERNOON SUN.

CHOOSE A PROTECTIVE SURFACING MATERIAL THAT HAS A CRITICAL HEIGHT VALUE TO MEET THE MAXIMUM FALL HEIGHT FOR THE EQUIPMENT (REF. ASTM F1487 STANDARD CONSUMER SAFETY PERFORMANCE SPECIFICATION FOR PLAYGROUND EQUIPMENT FOR PUBLIC USE, SECTION 8 CURRENT REVISION). THE SUBSURFACE MUST BE WELL DRAINED. IF THE SOIL DOES NOT DRAIN NATURALLY IT MUST BE TILED OR SLOPED 1/8" TO 1/4" PER FOOT TO A STORM SEWER OR A "TRENCH DRAIN".

AREA OF ACCESSIBLE/PROTECTIVE SURFACING (TURF SUGGESTED)
7,240 SF

DESIGNED BY:
AH

COPYRIGHT: 11/25/2025
LANDSCAPE STRUCTURES, INC.
601 7th STREET SOUTH - P.O. BOX 198
DELANO, MINNESOTA 55328
PH: 1-800-328-0035 FAX: 1-763-972-6091

Date	Previous Drawing #	Initials

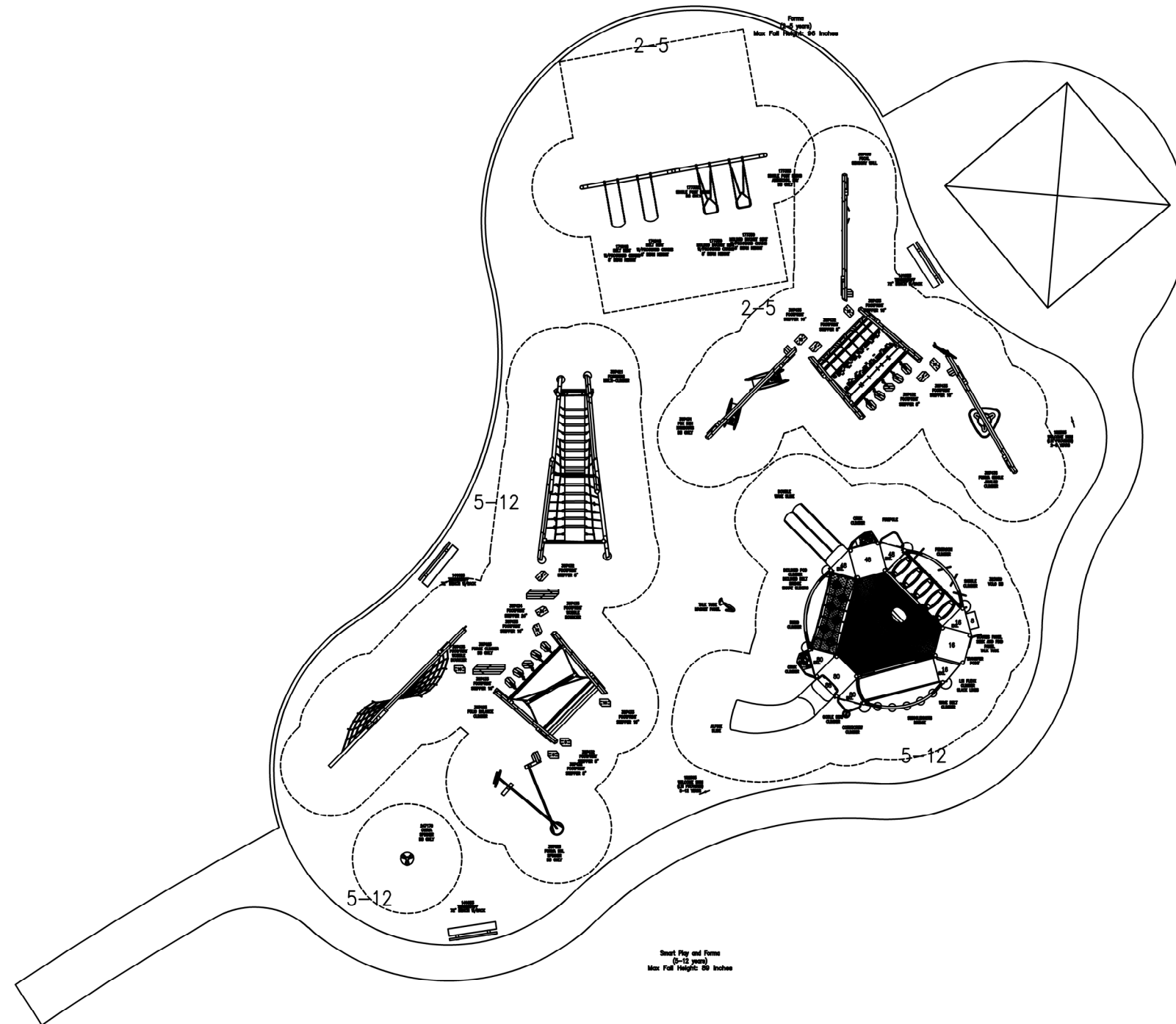

5-12 AREA

TOTAL ELEVATED PLAY COMPONENTS	15		
TOTAL ELEVATED COMPONENTS ACCESSIBLE BY RAMP	0	REQUIRED	0
TOTAL ELEVATED COMPONENTS ACCESSIBLE BY TRANSFER	12	REQUIRED	8
TOTAL ACCESSIBLE GROUND LEVEL COMPONENTS SHOWN	25	REQUIRED	4
TOTAL DIFFERENT TYPES OF GROUND LEVEL COMPONENTS	15	REQUIRED	15

2-5 AREA

TOTAL ELEVATED PLAY COMPONENTS	0		
TOTAL ELEVATED COMPONENTS ACCESSIBLE BY RAMP	0	REQUIRED	0
TOTAL ELEVATED COMPONENTS ACCESSIBLE BY TRANSFER	0	REQUIRED	0
TOTAL ACCESSIBLE GROUND LEVEL COMPONENTS SHOWN	23	REQUIRED	0
TOTAL DIFFERENT TYPES OF GROUND LEVEL COMPONENTS	9	REQUIRED	9

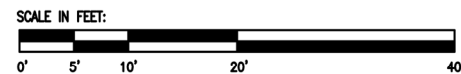

Pembroke Park
Birmingham, MI

Penchura, LLC
Lance Shipman

SYSTEM TYPE:
Forma/Smart Play
DRAWING #:
PEN1202880-01





Pembroke Park



PEN1202880-01 • 11.25.2025

© 2025 Landscape Structures. All Rights Reserved



LS landscape
structures

Pembroke Park



PEN1202880-01 • 11.25.2025

© 2025 Landscape Structures. All Rights Reserved



ls landscape
structures

Pembroke Park



PEN1202880-01 • 11.25.2025

© 2025 Landscape Structures. All Rights Reserved



Pembroke Park



PEN1202880-01 • 11.25.2025

© 2025 Landscape Structures. All Rights Reserved



Pembroke Park



PEN1202880-01 • 11.25.2025



Pembroke Park



PEN1202880-01 • 11.25.2025

© 2025 Landscape Structures. All Rights Reserved

Concept 1

Shown in a blue color
scheme

(Color change only)





landscape structures

Pembroke Park



PEN1202880-01 • 11.25.2025

© 2025 Landscape Structures. All Rights Reserved



LS landscape
structures

Pembroke Park

PEN1202880-01 • 11.25.2025



© 2025 Landscape Structures. All Rights Reserved



LS landscape
structures

Pembroke Park

PEN1202880-01 • 11.25.2025



© 2025 Landscape Structures. All Rights Reserved



 **landscape structures**

Pembroke Park

PEN1202880-01 • 11.25.2025

 **Penchura**



LS landscape
structures

Pembroke Park



PEN1202880-01 • 11.25.2025

© 2025 Landscape Structures. All Rights Reserved

Concept 2



2-12

Playground



The play components identified on this plan are IPEMA certified. (Unless model number is preceded with *) The use and layout of these components conform to the requirements of ASTM F1487. To verify product certification, visit www.ipema.org

THIS PLAY AREA & PLAY EQUIPMENT IS DESIGNED FOR AGES 2-12 YEARS UNLESS OTHERWISE NOTED ON PLAN.

IT IS THE MANUFACTURERS OPINION THAT THIS PLAY AREA DOES CONFORM TO THE A.D.A. ACCESSIBILITY STANDARDS, ASSUMING AN ACCESSIBLE PROTECTIVE SURFACING IS PROVIDED, AS INDICATED, OR WITHIN THE ENTIRE USE ZONE.

THIS CONCEPTUAL PLAN WAS BASED ON INFORMATION AVAILABLE TO US. PRIOR TO CONSTRUCTION, DETAILED SITE INFORMATION INCLUDING SITE DIMENSIONS, TOPOGRAPHY EXISTING UTILITIES, SOIL CONDITIONS, AND DRAINAGE SOLUTIONS SHOULD BE OBTAINED, EVALUATED, & UTILIZED IN THE FINAL DESIGN. PLEASE VERIFY ALL DIMENSIONS OF PLAY AREA, SIZE, ORIENTATION, AND LOCATION OF ALL EXISTING UTILITIES, EQUIPMENT, AND SITE FURNISHINGS PRIOR TO ORDERING. SLIDES SHOULD NOT FACE THE HOT AFTERNOON SUN.

CHOOSE A PROTECTIVE SURFACING MATERIAL THAT HAS A CRITICAL HEIGHT VALUE TO MEET THE MAXIMUM FALL HEIGHT FOR THE EQUIPMENT (REF. ASTM F1487 STANDARD CONSUMER SAFETY PERFORMANCE SPECIFICATION FOR PLAYGROUND EQUIPMENT FOR PUBLIC USE, SECTION 8 CURRENT REVISION). THE SUBSURFACE MUST BE WELL DRAINED. IF THE SOIL DOES NOT DRAIN NATURALLY IT MUST BE TILED OR SLOPED 1/8" TO 1/4" PER FOOT TO A STORM SEWER OR A TRENCH DRAIN.

AREA OF ACCESSIBLE/PROTECTIVE SURFACING (TURF SUGGESTED)
6,991 SF

DESIGNED BY:
AH

COPYRIGHT: 11/25/2025
LANDSCAPE STRUCTURES, INC.
601 7th STREET SOUTH - P.O. BOX 198
DELANO, MINNESOTA 55328
PH: 1-800-328-0035 FAX: 1-763-972-6091

Date	Previous Drawing #	Initials

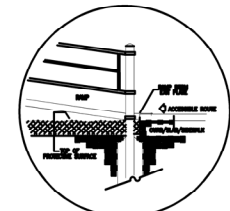
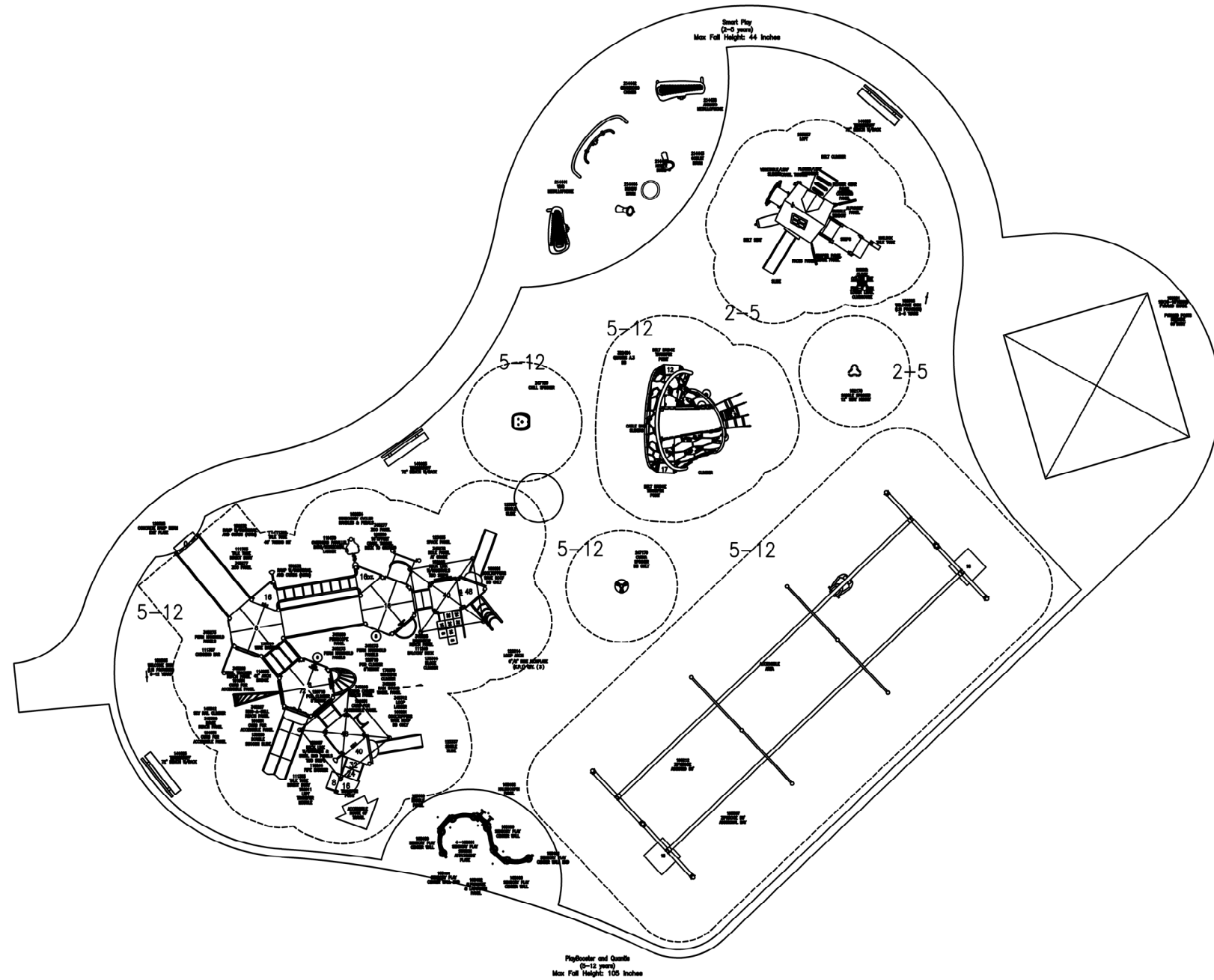

SUGGESTED RAMP BERM EXIT PLATE
8" / 12" / 16" DECK TO GRADE / 20" INSTALLATION
REFER TO RAMP BERM EXIT PLATE INSTALLATION SHEET

5-12 AREA

TOTAL ELEVATED PLAY COMPONENTS	20		
TOTAL ELEVATED COMPONENTS ACCESSIBLE BY RAMP	10	REQUIRED	5
TOTAL ELEVATED COMPONENTS ACCESSIBLE BY TRANSFER	6	REQUIRED	5
TOTAL ACCESSIBLE GROUND LEVEL COMPONENTS SHOWN	13	REQUIRED	7
TOTAL DIFFERENT TYPES OF GROUND LEVEL COMPONENTS	12	REQUIRED	12

2-5 AREA

TOTAL ELEVATED PLAY COMPONENTS	5		
TOTAL ELEVATED COMPONENTS ACCESSIBLE BY RAMP	0	REQUIRED	0
TOTAL ELEVATED COMPONENTS ACCESSIBLE BY TRANSFER	5	REQUIRED	3
TOTAL ACCESSIBLE GROUND LEVEL COMPONENTS SHOWN	8	REQUIRED	2
TOTAL DIFFERENT TYPES OF GROUND LEVEL COMPONENTS	6	REQUIRED	6



Pembroke Park
Birmingham, MI

Penchura, LLC
Lance Shipman

SYSTEM TYPE:
PlayBooster/Smart Play
DRAWING #:
PEN1202880-02





Pembroke Park



PEN1202880-02 • 11.25.2025

© 2025 Landscape Structures. All Rights Reserved



Pembroke Park



PEN1202880-02 • 11.25.2025

© 2025 Landscape Structures. All Rights Reserved



ls landscape
structures

Pembroke Park

 Penchura

PEN1202880-02 • 11.25.2025

© 2025 Landscape Structures. All Rights Reserved



Pembroke Park



PEN1202880-02 • 11.25.2025

© 2025 Landscape Structures. All Rights Reserved



Pembroke Park



PEN1202880-02 • 11.25.2025

© 2025 Landscape Structures. All Rights Reserved



Pembroke Park



PEN1202880-02 • 11.25.2025

© 2025 Landscape Structures. All Rights Reserved

Carpenter Lake Boulder Park

Heather Carmona <htcarmona@sbcglobal.net>
To: "Laird, Carrie" <Claird@bhamgov.org>, Scott Zielinski <szielinski@bhamgov.org>

Sun, Nov 16, 2025 at 9:04 AM

Hi Carrie and Scott,
Can you please share this with the board in our next packet?

My husband and I stumbled upon Carpenter Lake Nature Preserve. It's off of 10 Mile in Southfield and worth a trip. They have a forested loop around a small damn lake and some great interpretive signage. The highlight is a boulder Park with different types of rock brought in from various parts of the UP in conjunction with Cranbrook science center. got me thinking about other amenities in the Parks for older kids, adults and things that are a little less manufactured and more natural. Really really cool and worth visiting.

I hope you both have a great Thanksgiving. Thankful for everything you do!

Heather Carmona
248.867.1346

4 attachments



PXL_20251110_203400583.jpg
4900K



PXL_20251110_203323656.jpg
5440K



PXL_20251110_203236877.jpg
4716K



PXL_20251110_203354026.jpg
3619K

THE BOULDER GARDEN AT CARPENTER LAKE

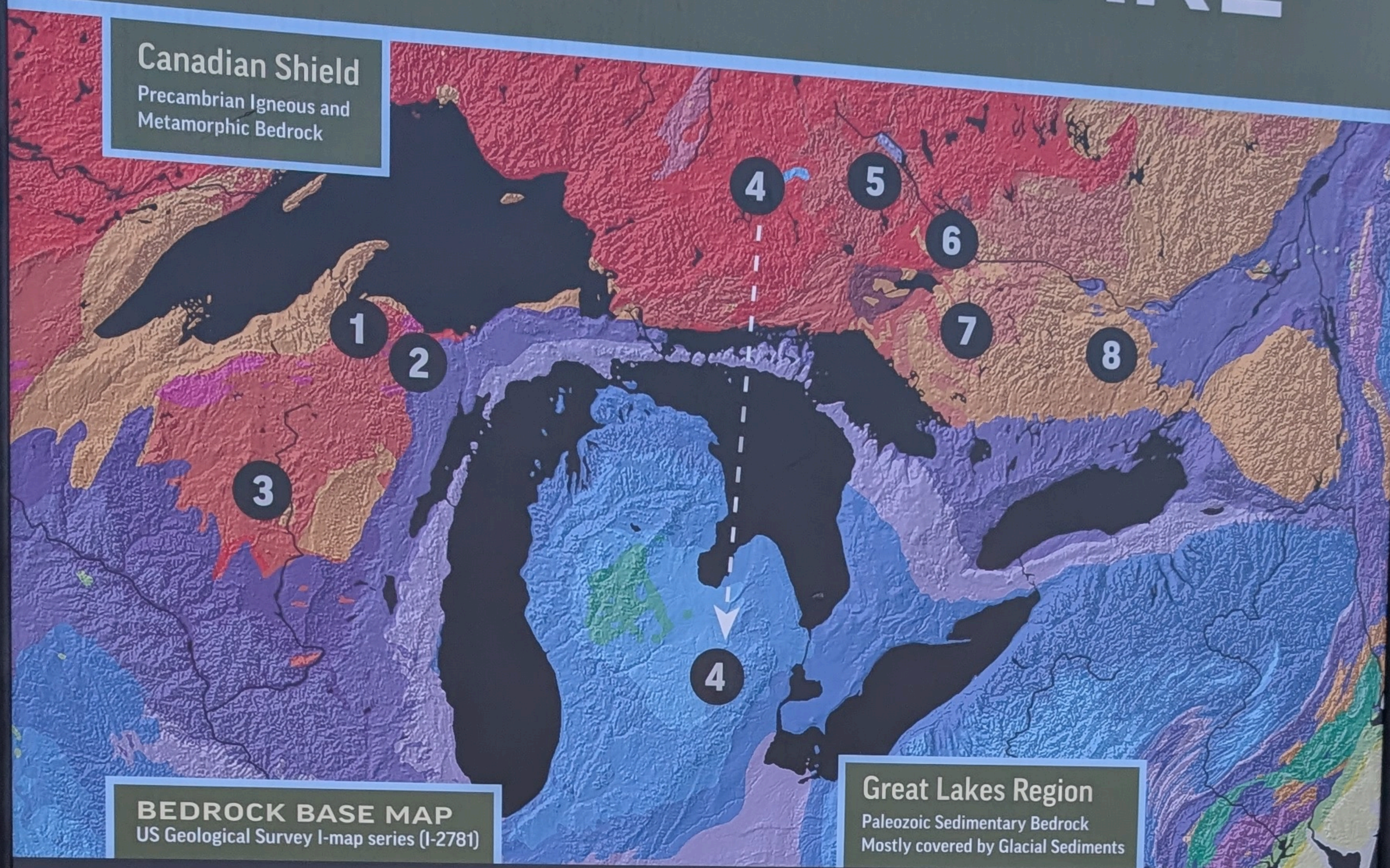

These rocks were collected from bedrock exposures at the numbered localities except for those from site 4, which were glacially transported over 400 miles to SE Michigan roughly 16,000 years ago and excavated from the Ray Road Gravel Quarry near Oxford MI.

1. Marquette, MI | 2. Groveland Mine, MI | 3. Wausau, WI | 4. Oxford, MI | 5. NE, ONT
6. Timiskaming, QUE | 7. Huntsville, ONT | 8. Kingston, ONT

Welcome to the Boulder Garden at Carpenter Lake. The rocks assembled here were collected directly from the bedrock of the western Upper Peninsula of Michigan, Wisconsin, SE Ontario, and from local glacial deposits at the Ray Road Quarry near Oxford Michigan. They range in age from 1 to 2.7 billion years old and provide remarkable evidence of the early geological evolution of Michigan and the Great Lakes region including a record of explosive and submarine volcanism, the former existence of Himalayan-sized mountains now eroded to their roots, the evolution of the atmosphere and oceans, the formation of important natural resources, and the ice age glaciation of Michigan. Please be careful as you explore and do not climb on the rocks!

For additional science content information, visit the Boulder Garden at Carpenter Lake web page hosted by Cranbrook Institute of Science | science.cranbrook.edu/discover/glacial-boulder-project



Acknowledgements: The Boulder Garden at Carpenter Lake was made possible through the generous financial donation of Marshall Lasser - who is also responsible for the artistic design. The Boulder Garden was constructed by Ray Rogers of Rockworks, LLC. John Zawiskie of Cranbrook Institute of Science was the primary science content resource with additional scientific editing and input by Dr. Andrew Gangidine of Cranbrook Institute of Science. The production, exhibit graphics and photography were done by Kyle Staulter of New Graphix. Mayor Kenson Siver championed this project and facilitated it through the approval processes. The City of Southfield provided permission and additional financial support for the project.

Southfield
the center of it all™

CRANBROOK
INSTITUTE OF
SCIENCE
Michigan's Museum of Natural History







Parks & Rec Meeting Tonight

1 message

Marci Hensley <marcihensley@hotmail.com>

Tue, Dec 2, 2025 at 9:45 AM

To: "cfolk@bhamgov.org" <cfolk@bhamgov.org>

Cc: "claire@bhamgov.org" <claire@bhamgov.org>, Tracy Devries <tdevries@birmingham.k12.mi.us>

Dear Connie,

Attached is a letter from the Fifth Grade Student Leadership Team at Pembroke Elementary.
Could you please include it in the packet for tonight's Parks and Recreation Meeting?

The team brainstormed a few ideas for the Pembroke Park renovation. They hope the board will take them into consideration!

Thank You,

Marci Hensley

 **Pembroke Park Letter 12.1.25.pdf**
30K

December 1, 2025

Dear Board Members,

Our Student Leadership Team has been thinking of ideas for the Pembroke Park renovation. Our families and students surround the park on four sides. These are a few of the ideas that we came up with.

- We can make adjustable basketball hoops and multiple courts. To make it easy and fun to play for all ages and sizes including kids with disabilities.
- We can also make multi-kid swings for disabled kids or kids who don't like to swing alone.
 - We have a student in a wheelchair who said she would love it if it was a 3-4 kid swing or even a "pirate ship" type swing where kids can sit next to each other, and she can wheel up to it.
- Have a rubber mat ground instead of a wood chip ground to make it easier for kids in wheelchairs to move around.

We are working on other ideas and hopefully can present them at another meeting.

Sincerely,

Connor Tate

Student Leadership Member
Pembroke Elementary School



MEMORANDUM

Department of Public Services

DATE: November 25, 2025

TO: Parks and Recreation Board

FROM: Carrie Laird, Parks & Recreation Manager

SUBJECT: City-wide Playground Project Update

The West Lincoln Well Park Playground was completed the week of November 10, 2025 and the Pumphouse Park Playground shortly thereafter, the following week of November 17, 2025. Photos of the completed projects are attached. The community has expressed much gratitude and excitement for these new playgrounds!

The Poppleton Park Fully Inclusive Playground project was approved by the City Commission on November 17, 2025. The DPS is looking forward to the installation in the spring of 2026!









Tablero de comunicación

✓	👁️	👂	➡️	👉	👈
✗	👤	👤	👤	👤	👤
👤	👤	👤	👤	👤	👤
?	👤	👤	👤	👤	👤
?	👤	👤	👤	👤	👤
👤	👤	👤	👤	👤	👤
👤	👤	👤	👤	👤	👤
A	B	C	D	E	F
G	H	I	J	K	L
M	N	O	P	Q	R
S	T	U	V	X	Y
Z	1	2	3	4	5
6	7	8	9	0	







MEMORANDUM

Department of Public Services

DATE: November 25, 2025

TO: Parks and Recreation Board

FROM: Brad McNab, Parks & Recreation Foreman

SUBJECT: Playground Closings During Freezing Temperatures

As winter approaches and temperatures continue to fall, playground conditions can become hazardous. Engineered wood fiber (EWF) and other natural surfacing materials can freeze solid. As playground surfacing stiffen it causes a loss of its shock-absorbing properties. Falls that might cause only minor scrapes in warmer months can lead to bruises, fractures, or head injuries under frozen conditions. For this reason, the Parks and Recreation Division of the Department of Public Services considers all playgrounds closed when temperatures fall below 32°F (0°C), greatly reducing their ability to cushion falls. These seasonal changes require proactive public communication and temporary closures to protect community safety.

To ensure residents are informed, winter playground safety guidance will be included in the December *Around Town* newsletter. Additionally, closure notices and safety reminders will be posted at all playgrounds throughout the season.



BIRMINGHAM
A WALKABLE CITY

PLAYGROUND CLOSED DURING FREEZING TEMPERATURES

For your safety, this playground is closed when temperatures are below 32°F (0°C).

Frozen surfaces can become extremely hard and slippery, increasing the risk of serious injury from a fall.

Please keep children off all equipment until temperatures rise above freezing.

Thank you for helping keep our community safe.

