



Agenda
Parks and Recreation Board Regular Meeting
Tuesday, February 3, 2026 - 6:30 PM
851 S. Eton, Birmingham, MI
DPS Conference Room

- I. Call to Order**
- II. Roll Call**
- III. Announcements, Introductions of Guests & Chairpersons Comments**
- IV. Open To The Public for Items Not On the Agenda (two minutes per person)**
- V. Approval of the Minutes from the Previous Meeting**
 - 1. January 13, 2026, Parks and Recreation Board Minutes
- VI. Unfinished Business**
- VII. New Business**

Written and submitted by 5pm Monday at the Birmingham Ice Sports Arena, one week prior to the meeting.

 - 1. Pembroke Park Playground Update
- VIII. Miscellaneous Communications**
- IX. Reports From Staff**
- X. Items for Next Meeting on March 10, 2026**
- XI. Adjournment**

Link to Access Virtual Meeting: <https://zoom.us/j/98191466679>

Telephone Meeting Access: 877 853 5247 US Toll-free

Meeting ID Code: 981 9146 6679

PARKS & RECREATION BOARD MISSION STATEMENT

The Parks and Recreation Board strives to provide opportunities for the enjoyment, education, and inspiration for present and future generations of residents and visitors through stewardship of natural, cultural and recreational resources. By continuously elevating the beauty and quality of the parks and recreation system of Birmingham, the Parks and Recreation Board will promote health and wellbeing, and strengthen the community.

You may also present your written statement to: City of Birmingham, Parks and Recreation Board 851 South Eton, Birmingham, Michigan 48009 prior to the meeting.

If you cannot attend the meetings, please contact Clinise Kirkwood at the Birmingham Ice Arena (248) 530-1651. Minutes are available for review at the Birmingham Ice Sports Arena, 2300 East Lincoln, Birmingham, MI 48009

Individuals requiring accommodations, such as interpreter services, for effective participation in this meeting should contact the City Clerk's Office at (248) 530-1880 (voice) or 248-644-3405 (TDD) at least one day in advance to request mobility, visual, hearing, or other assistance.

Las personas con incapacidad que requieren algún tipo de ayuda para la participación en esta sesión pública deben ponerse en contacto con la oficina del escribano de la ciudad en el número (248) 530-1800 o al (248) 644-3405 (para las personas con incapacidad auditiva) por lo menos un día antes de la reunión para solicitar ayuda a la movilidad, visual, auditiva, o de otras asistencias. (Title VI of the Civil Rights Act of 1964)



**Parks And Recreation Board – Regular Meeting Minutes
January 13, 2026 – 6:30 p.m.
851 South Eton - Conference Room**

I. Call to Order

The meeting was called to order at 6:30 p.m.

II. Roll Call

Present: Chair Heather Carmona, Vice Chair Pam Graham; Board Members Susan Collins, Jessica Einstein, Anne Lipp; Alternate Board Members Narlu Castellano, Joseph Wrobel

Absent: Board Member Sarah Kupczyk

Staff: Department of Public Services Director Zielinski; City Planner Blizinski, Ice Arena and Facilities Superintendent Folk, Recreation Coordinator Kirkwood, Parks and Recreation Manager Laird

III. Announcements, Introductions of Guests & Chairpersons Comments

A. Golf Course Green Fees Subreport

DPSD Zielinski asked to amend the agenda to add the Golf Course Green Fees Subreport.

Motion by Einstein
Seconded by Lipp to add it.

Motion carried, 7-0.

ROLL CALL VOTE

Yeas: Einstein, Castellano, Wrobel, Carmona, Collins, Graham, Lipp
Nays: None

**B. City Commission Long Range Planning Meeting Saturday, January 24,
2026 – 8:30 AM**

IV. Open To The Public for Items Not On the Agenda

None.

V. Approval of the Minutes – December 2, 2025

Ms. Lipp recommended a change to the minutes.

Motion by Collins

Seconded by Lipp to accept the minutes with the corrections given.

Motion carried, 7-0.

ROLL CALL VOTE

Yeas: Einstein, Castellano, Wrobel, Carmona, Collins, Graham, Lipp

Nays: None

VI. Unfinished Business

A. Park Rules & Regulations

PRM Laird introduced the item. Staff answered questions regarding the item.

Board members discussed the following regarding the item:

- The penalty for tennis instruction without a permit should be clarified as being pursuant to rule 35.
- Unpaid, non-professional tennis instruction at the tennis courts should likely not require a permit.
- It would be useful to note in writing that tennis professionals must carry liability insurance and must provide that information to the City in order to receive a permit.
- The boating section only intends to prohibit remote control or full-size motorized boats from using Quarton Lake. It does not intend to prohibit non-motorized boats such as canoes, kayaks, or rowboats.
- Since staff indicated that changes to this item would require an hour of City Attorney review, the benefits of the aforementioned changes would likely not be significant enough to outweigh that cost. Consequently, the Rules and Regulations should likely be moved forward as-is.

Motion by Lipp

Seconded by Collins to approve the updated Park Rules and Regulations and updated language on posted park signage. Further, to recommend the Park Rules and Regulations be considered for adoption by the City Commission.

Motion failed, 3-4.

Board members discussed the following regarding the item:

- Rules 33 and 34 might conflict and should be discussed before approving the Rules and Regulations.

ROLL CALL VOTE

Yeas: Castellano, Carmona, Collins

Nays: Graham, Lipp, Einstein, Wrobel

Board members continued discussion regarding the item:

- Rule 33 and 34 might conflict.
- The end of Rule 33 could say 'except as set forth in Rule 34', and the beginning of Rule 34 could have 'Notwithstanding Rule 33' added.
- The rules should be able to stand on their own.
- Alternatively, the Board is not tasked with doing the statutory interpretation of these rules and regulations. That is within the City Attorney's purview.
- It is within the Board's charge to make sure the rules and regulations are clear. Focusing on the underlying intent is appropriate.
- From a drafting standpoint, Rules 33 and 34 could be clarified.
- It might be most appropriate to approve these rules and regulations as-is, to monitor the situation, and to amend the rules and regulations as necessary.
- When updates to the rules and regulations are next proposed, Board members are encouraged to do a thorough read of the first draft and to provide any recommended revisions to staff in advance of the Board discussion.
- The rules and regulations are not necessarily reviewed on an annual basis.
- The heading could say 'Electric Bikes (e-bikes) Exception' for clarity.
- It may not be necessary to clarify because reading Rules 33 and 34 would still likely sufficiently lead a reader to the correct conclusions.

Motion by Lipp

Seconded by Collins to approve the updated Park Rules and Regulations and updated language on posted park signage. Further, to recommend the Park Rules and Regulations be considered for adoption by the City Commission.

Motion carried, 7-0.

ROLL CALL VOTE

Yeas: Graham, Lipp, Einstein, Wrobel, Castellano, Carmona, Collins

Nays: None

VII. New Business

A. Design Services — St. James & Kenning Parks Presentations & Interviews

- **Dul Landscape Architecture**
- **Nowak & Fraus**
- **OHM**

PRM Laird introduced the item. Each team was interviewed by the Board. No team was in the room during another team's interview. Staff answered questions regarding the item.

Board members discussed the following regarding the item:

- Staff earned thanks for getting well done submittals from qualified contractors.
- Each team seemed very capable.
- OHM offered enthusiasm, a wide range of resources, and a low bid price.
- Community engagement is a high priority, and OHM seemed very capable in that respect. They were the only team that said it would go to the parks to solicit feedback.
- OHM seemed to give the best presentation with the most specific examples.
- All the teams' quoted costs were around \$10,000 - \$20,000 of each other.
- Nowak & Fraus seemed to have done a lot of research into understanding Birmingham, which was appreciated. Their presentation seemed to indicate a strong focus on the engineering aspects of the projects with less of a focus on the design aspects.
- OHM's work at the Sylvan Glen Park in Troy, Michigan was a testament to their capacity and their ability to work in a context that has some similarities to Birmingham.
- OHM had a more diverse team during the presentation, demonstrated interest in a diversity of input from different stakeholders, and demonstrated diversity in design approaches.
- Dul Landscape Architecture's other work in the City has been well done. Their answers were not particularly specific, and their presentation seemed to rely heavily on their previous work in Birmingham.
- OHM's lack of experience within Birmingham parks specifically could be a strength because it could be an opportunity to integrate some fresh perspectives from other communities.
- Checking the references of the selected team will be important to verify that they can deliver the experience being presented.
- Nowak & Fraus was the only team that proposed specific plans for the parks. Their specificity was appreciated.
- OHM demonstrated an understanding of the timeline of the project. They were also the only team that raised some well thought out potential concerns with the timeline for Kenning Park.
- Since the Board did not have feedback from any of the teams' references yet, it may not be appropriate to use that part of the rubric.
- It was unclear whether 'quality of materials' in the rubric referred to the physical materials the teams might plan to use in the parks, or whether it referred to the evening's presentation materials.
- The Board unanimously agreed that OHM was the top team. Staff's ranking, in contrast, was not unanimous.

Motion by Einstein

Seconded by Lipp to strike references.

Board members discussed the following regarding the motion:

- Removing the references aspect of the rubric could be fine.
- It would also work if an individual scored the reference portion the same for all three firms, if they felt they lacked sufficient information.

Motion failed, 0-7.

VOICE VOTE

Yeas: None

Nays: Einstein, Castellano, Wrobel, Carmona, Collins, Graham, Lipp

The Board entered into recess while staff calculated the rankings, and returned from recess.

Motion by Lipp

Seconded by Castellano to recommend OHM as the selected Consultant for Design Services for St. James and Kenning Parks to the City Commission for approval.

Motion carried, 7-0.

ROLL CALL VOTE

Yeas: Einstein, Castellano, Wrobel, Carmona, Collins, Graham, Lipp

Nays: None

B. Golf Course Green Fees Subreport

DPSD Zielinski presented the item and answered questions from the Board.

Board members discussed the following regarding the item:

- The higher price increases are for the lower volume items. If the prices are increased a bit for the higher volume items, the City would have an opportunity to generate more revenue.
- A two dollar increase would likely not be a deterrent for those looking to play a round of golf in Birmingham.
- It might make sense to explore pricing the golf courses differently.

Motion by Lipp

Seconded by Einstein to increase golf course green fees, effective March 1, 2026, to contribute directly to infrastructure improvements at Springdale and Lincoln Hills Golf Course. Furthermore, to recommend the golf course green fees increase to the City Commission for approval.

Motion carried, 7-0.

ROLL CALL VOTE

Yeas: Einstein, Castellano, Wrobel, Carmona, Collins, Graham, Lipp

Nays: None

VIII. Miscellaneous Communications

Board members discussed the following:

- The new City minutes template was being pre-populated with information referencing City Hall that did not apply to the Parks and Recreation Board meetings and should be corrected.
- Discussing golf, ice arena, and dog park programming would be of interest.

- Receiving an update on the City's progress towards its strategic plans would be helpful.

IX. Reports from Staff

A. National Fitness Campaign — Review Information & Options

B. Playground Updates

C. Celebrating America's 250th Anniversary

X. Items for Next Meeting

XI. Adjournment

The meeting was adjourned at 9:49 p.m.



Connie Folk, Ice Arena and Facilities Superintendent

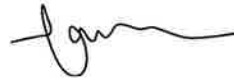

Laura Eichenhorn, City Transcriptionist



MEMORANDUM

Department of Public Services

DATE: January 26, 2026

TO: Parks and Recreation Board

FROM: Brad McNab, Parks and Recreation Foreman
Carrie Laird, Parks and Recreation Manager

SUBJECT: Pembroke Park Playground Improvements

INTRODUCTION:

Over the past several months, the Department of Public Services (DPS) has been advancing plans for citywide playground improvements, with a focus on enhancing safety, accessibility, and play value across Birmingham’s park system. Through the MITN/BidNet procurement process, the City has secured a multi-year contract with Penchura, LLC to provide professional playground design services. As part of this initiative, Pembroke Park has been identified as the next priority location for playground replacement, reflecting its heavy neighborhood use. The planned improvements will ensure the playground meets current safety standards, supports inclusive play opportunities, and aligns with the City’s long-term Parks and Recreation goals.

BACKGROUND:

As part of the City’s Playground Improvements Program, the DPS implemented a public engagement process to inform residents about the planning and design of the new Pembroke Park playground and to gather community feedback. Outreach efforts included targeted communication to nearby residents and park users through social media, City communication platforms, and coordination with neighborhood associations. A public input opportunity was also provided at the December 2, 2025 Parks and Recreation Board meeting, allowing community members to share feedback directly with City staff. In addition, an online survey was made available through Engage Birmingham to collect broader input on playground preferences and conceptual design elements. Feedback gathered through these engagement efforts was incorporated into the proposed Pembroke Park playground design to ensure it reflects neighborhood priorities, supports inclusive and multigenerational play, and aligns with the City’s long-term Parks and Recreation goals.

LEGAL REVIEW:

The City Attorney conducted a review of the contract with Penchura earlier this year.

FISCAL IMPACT:

The 2025-2026 approved budget for the Pembroke Park Playground Improvements is \$600,000. The cost estimates for the Pembroke Park Playground Improvement are currently estimated at approximately \$663,046.81. Money is available in the Parks System Construction Fund. Final budget to be approved by City Commission.

PUBLIC COMMUNICATIONS:

City staff, in coordination with Penchura, LLC, sought public input from nearby residents, park users, and other stakeholders through engagement opportunities such as surveys and a public workshop. Feedback gathered through this process will help inform the final playground design to ensure it reflects community needs, supports inclusive and intergenerational play, and reinforces Pembroke Park's role as a neighborhood gathering space.

SUSTAINABILITY:

The playground equipment by Landscape Structures incorporated in this design offers the most comprehensive warranties, leading to a longer lifespan. Landscape Structures is an International Organization for Standardization (IOS) certified, meeting quality and environmental standards. The equipment additionally meets or exceeds standards for equipment set by the International Play Equipment Manufacturers Association (IPEMA), Consumer Product Safety Commission (CPSC), ASTM International (formerly the American Society for Testing and Materials), Canadian Standards Association (CSA), and European Committee for Standardization (ECS), among others.

The design incorporates a holistic approach, and consideration is given to drainage, shade structures, native trees, and the incorporation of recycled products, all contributing to a sustainable end product.

DESIGN CONSIDERATIONS:

The proposed Pembroke Park playground is designed to be inclusive and accessible, featuring a continuous poured-in-place (PIP) safety surface throughout the majority of the play area to ensure ease of movement for wheelchairs, strollers, and mobility devices. The layout includes wheelchair-accessible play components allowing children and caregivers of varying abilities to participate in play together. The primary play structure is designed with accessible routes that extend to elevated play elements, offering meaningful and engaging experiences at multiple levels.

A key intent of the Pembroke Park design is to integrate inclusive play elements in a way that feels natural and engaging for all users. Rather than separating accessible features, the playground is designed so children of all abilities can play side by side, encouraging social interaction, shared experiences, and healthy physical challenges in an inclusive environment.

The playground also supports multigenerational use, with equipment and features that can be enjoyed by older children, adults, and seniors. Inclusive swings and an accessible track ride provide generous space, comfortable seating, and ease of access, making it possible for grandparents and caregivers to actively participate in play alongside children.

In addition to active play, the Pembroke Park design incorporates opportunities for passive recreation. Open lawn areas allow for informal activities such as lawn games or quiet relaxation, while benches and shaded seating areas are strategically placed throughout the park. These features ensure Pembroke Park remains an inclusive neighborhood space where all residents feel welcome and comfortable.

SUMMARY:

The City of Birmingham, through the DPS, is advancing the next phase of its Citywide Playground Improvements Program with the proposed redesign and replacement of the playground at Pembroke Park. Supported by a multi-year professional design contract with Penchura, LLC, the project prioritizes safety, accessibility, and inclusive play in alignment with the City's Parks and Recreation Master Plan.

The project is funded in the 2025–2026 Parks System Construction Fund and incorporates public input gathered from nearby residents and park users to ensure the design reflects community needs. The proposed playground emphasizes accessibility, multigenerational use, and sustainable design practices, while meeting or exceeding all applicable safety and environmental standards. Upon completion, the new Pembroke Park playground will strengthen the park's role as a neighborhood gathering space and provide high-quality recreational opportunities for residents of all ages and abilities.

ATTACHMENTS:

- Engage Birmingham Survey Results
- Pembroke Site Concept Plan, Playground Layout, and 3D Renderings
- Cost Estimates

SUGGESTED BOARD ACTION:

To approve the updated draft concept plan and playground layout for the Pembroke Park Playground Improvement project as presented, and to forward to the City Commission for their consideration and final approval.

Pembroke Park Playground Survey

SURVEY RESPONSE REPORT

29 April 2021 - 04 January 2026

PROJECT NAME:

Pembroke Park Playground Improvements



SURVEY QUESTIONS

Q1 How do you typically travel to Pembroke Park Playground?

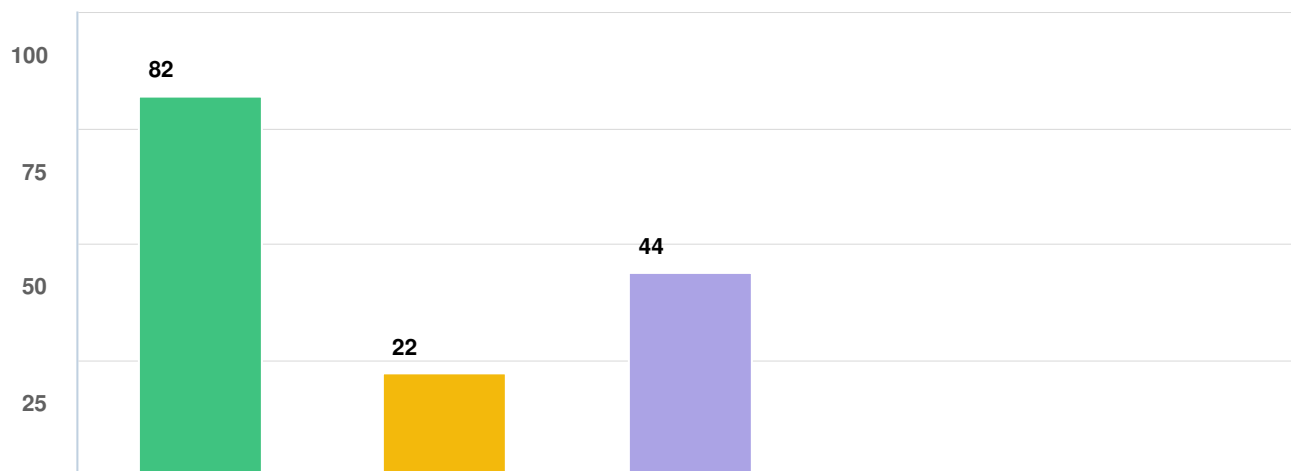

Question options

- Walk
- Bike
- Drive
- Other (please specify)
- Public Transportation

Optional question (111 response(s), 2 skipped)
Question type: Checkbox Question

Q2 How often do you visit Pembroke Park Playground?

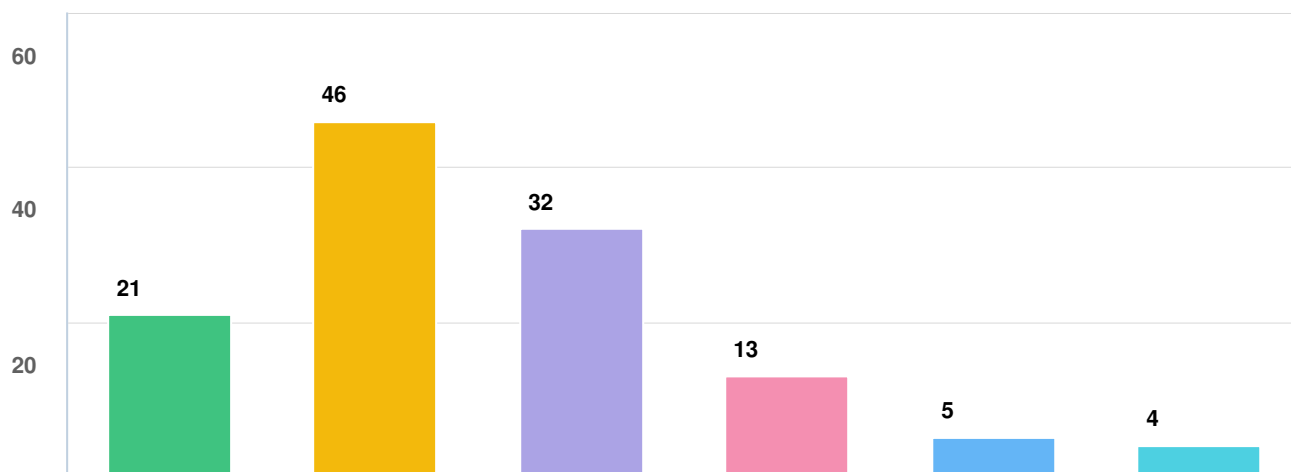

Question options

- Daily
- Weekly
- Monthly
- Yearly
- Less than 1 time per year
- None at all

Optional question (111 response(s), 2 skipped)
Question type: Checkbox Question

Q3 What is the age of the playground user in your household, or if you're visiting without a household member, the age of the ...

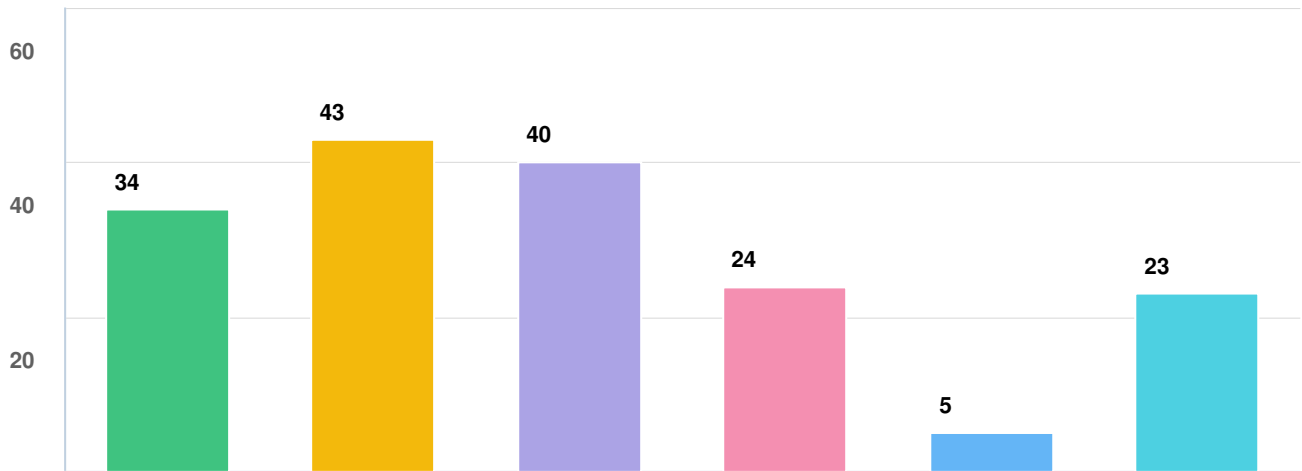

Question options

- 0-2 years
- 3-5 years
- 6-8 years
- 9-12 years
- 13-17 years
- 18+ years

Optional question (107 response(s), 6 skipped)
 Question type: *Checkbox Question*

Q4 How important is accessibility to you when using the park (e.g., rubberized surfacing for wheelchair access, sidewalks, res...)

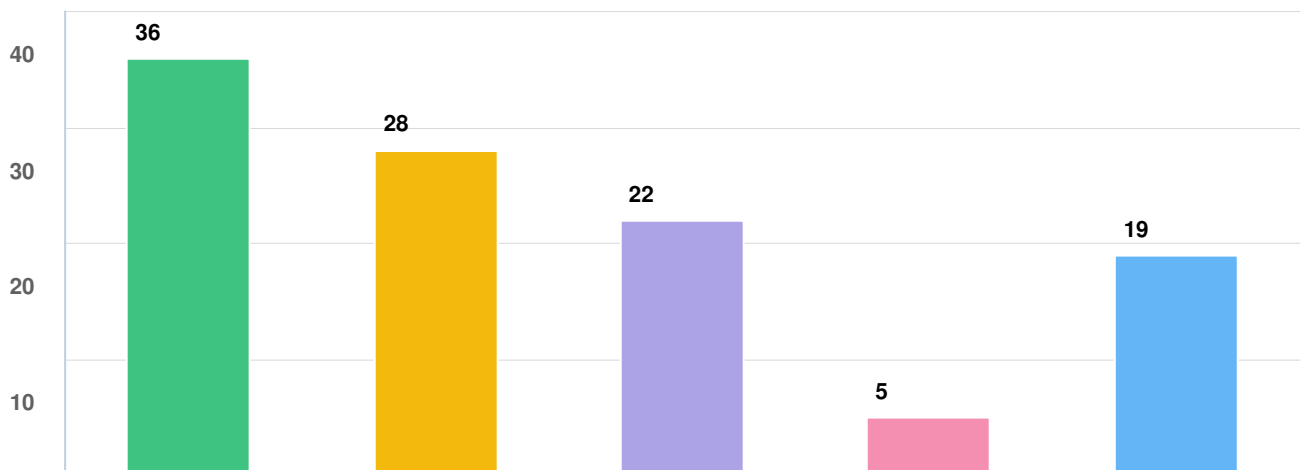

Question options

- Very important
- Somewhat important
- Neutral
- Slightly important
- Not important

Optional question (110 response(s), 3 skipped)
 Question type: *Checkbox Question*

Q5 | Please rank the features you would most like to see included in the new playground from highest to lowest interest. With # ...

OPTIONS	AVG. RANK
Swings	3.49
Slides	4.18
Adventure play structures (rope towers, net bridges, obstacle courses)	4.25
Climbing elements	4.61
Nature-based play elements (logs, climbing boulders, tunnels)	5.44
Shaded seating nooks with benches or porch swings	6.27
Monkey bars	6.90
Sandboxes	7.65
Spinners/Bouncers	8.05
Sensory gardens (native plants, textures, scents, pollinator beds)	8.12
Inclusive playground equipment (adaptive swings, wheelchair-accessible spinners)	8.29
Musical play instruments (drums, chimes, xylophones)	8.82

Optional question (106 response(s), 7 skipped)
Question type: Ranking Question

Q6 | Would you like to see a shaded structure/picnic area added to the Pembroke Park Playground?

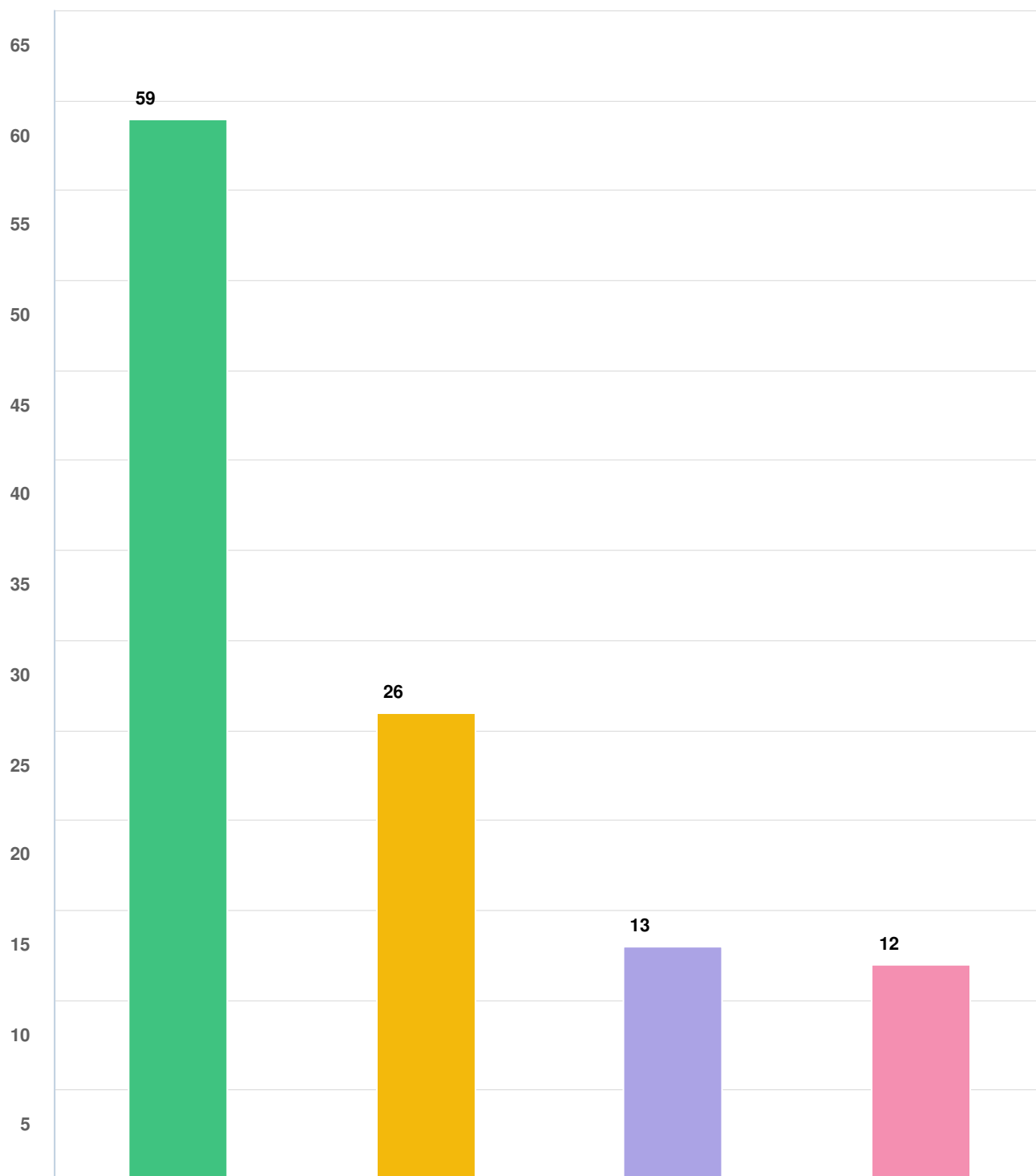

Question options

- Yes, definitely
- Maybe / No preference
- No, not necessary
- No, I prefer open seating instead

Optional question (110 response(s), 3 skipped)
Question type: Checkbox Question

Q7 Based on your review of concept 1 and concept 2, which concept option do you prefer?

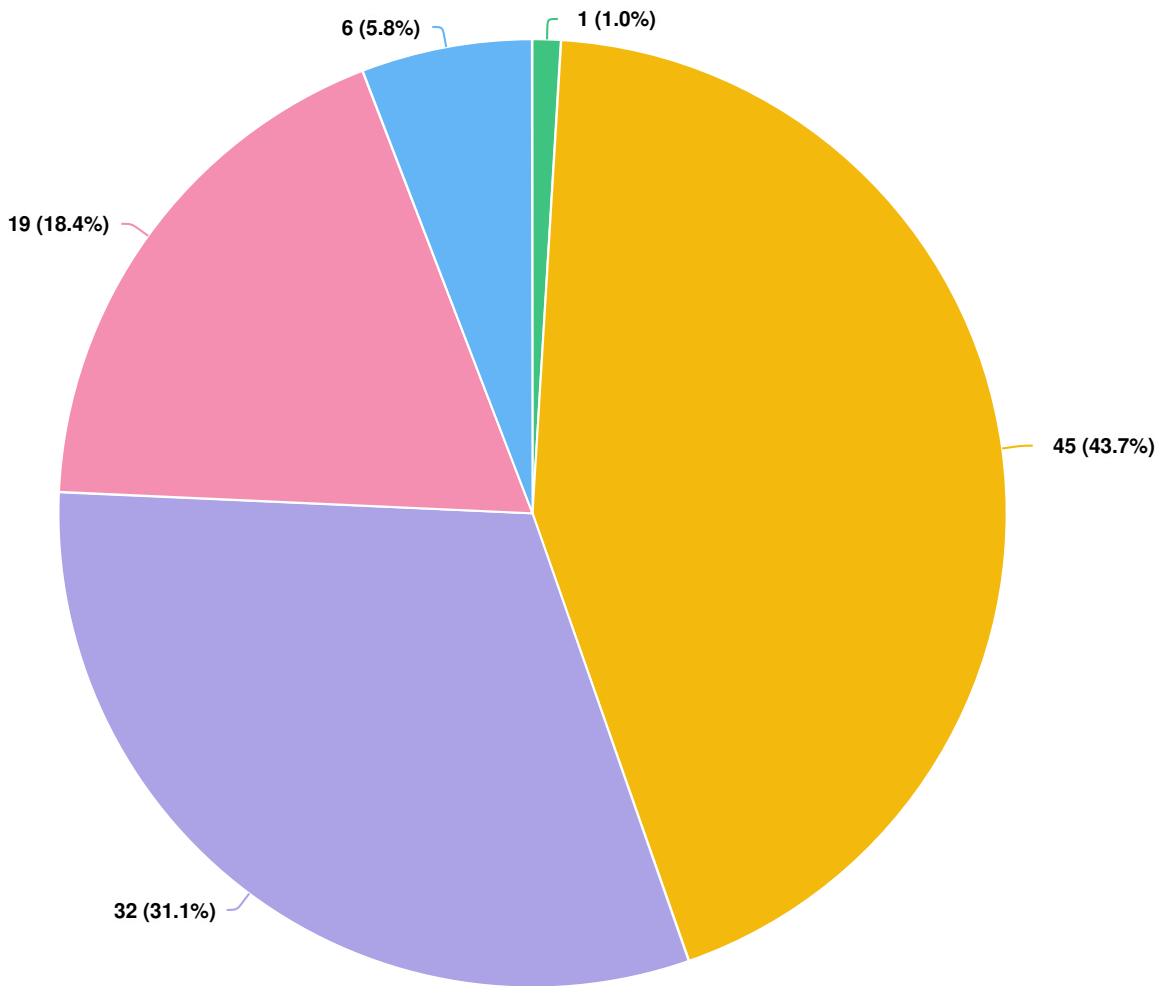

Question options

- Other (please specify)
- Concept 1 in burgundy
- Concept 1 in blue
- Concept 2
- None of the above

Optional question (103 response(s), 10 skipped)
Question type: Dropdown Question

Q8 | Is there anything you feel is missing from these concepts?

Kfrei1

12/05/2025 09:28 AM

Please keep the existing sandboxes, these are well used and loved. As well as all the mature trees that provide existing natural shade during the hot summer. We also need more swings. From the concepts it is unclear what this is replacing. But two swings is not enough for how crowded this park gets and no baby swings. Keep the long bank of kid and baby swings that are existing. Can we get a tandem parent/baby swing like they have at beach road park in Troy? We also need a walkway into the park for strollers and stroller parking. There is no where to stash stroller, wagons, bikes, etc. there is a very small pad and one bench near the northwest corner. Provide extra bike racks. Please add a sidewalk down the north and south sides of the park so you can do a walking loop of the park, currently it's very limited. Would be nice to walk with the baby around and watch the older kids play at the same time. Also could use bathrooms. More than just the lonely port o potty near the soccer field. Maybe a second one? Or permanent duo. And to be honest all these parks are becoming more and more climbing structures and these are hard to do for some kids. The ropes are very unsteady. Can we get something like beach road park or Adam's park that's more solid less dangly ropes?

kobrien18

12/05/2025 09:29 AM

It would be nice if Concept 2 had a swinging set; Neither concept seems to include any sort of spring riders or teeter-totter elements which might be nice.

Nina Bernardi

12/06/2025 04:05 AM

A larger play space similar to what exists for younger and older kids. Two separate spaces.. There are not nearly enough swings in either of these plans.

cwojew

12/08/2025 07:44 AM

There needs to be more swings in both concepts. At least 4 big swings and 4 baby swings. The basketball court should be completely redone and made into a full court with two nets - kids are always playing basketball there and a better court would be great. Sullivan Park in Royal Oak has a circular swing (NOT a tire swing) that all the kids love, that would be a good addition.

Trina0522

12/08/2025 09:13 AM

If possible, maybe add the playhouse to concept 1 for younger children. Also maybe adding a restroom area.

Halliecurran1
12/08/2025 04:35 PM

Toilets

Maple
12/08/2025 04:36 PM

Toilets Drinking fountains not from the 1920s.

Corinnefoote
12/08/2025 04:38 PM

Fenced in play area would be nice

AnnaWhittier
12/08/2025 04:49 PM

Sandboxes are missing. If you go to Pembroke Park on a regular basis. Every single child at the park plays in the sandbox for at least half their time at the park.

debimarques
12/08/2025 05:46 PM

Concept 1 is super nice. Concept 2 reminds me of the new Adams playground, which is too close to pembroke to be so similar.

HR
12/08/2025 06:00 PM

Benches

dancerkdgood
12/08/2025 06:36 PM

We liked the colors of 2 but play equipment on 1. Also we liked the shades on part of 2, it's nice to have shade on hot days. Favorite equipment is zip lines and different cool swings.

Mellos4
12/08/2025 06:45 PM

No

Spartymom68
12/08/2025 06:45 PM

Seating

Jaimezavier
12/08/2025 11:07 PM

NA

Ebwelch
12/09/2025 05:55 AM

Please try to keep as many trees as possible. We love the natural shade.

Korrie926
12/09/2025 06:28 AM

I enjoy a smaller play area for smaller kids. Bigger area for bigger kids.

Lizmkauf
12/09/2025 12:03 PM

The park is used by babies and their care givers . Infant swings are a must . The concept of all equipment together is not a positive concept

for this park .

Pembroke Resident

12/09/2025 06:35 PM

Spread out the structures give kids space to explore.

Michael Dery

12/09/2025 06:43 PM

Was between Concept 1 and None of the above...we are missing a Sandbox plus it also is missing swings for children and adults. Lastly - why are we making a spacious park feel so small. Part of the charm is the ability to run around.

Emileedecker

12/09/2025 07:10 PM

One concern I have with the current playground design approach is that play structures meant for a wide age range are placed extremely close together. While the intention is to create an inclusive space, it can actually create safety issues and limit the quality of play for everyone involved. Toddlers, young children, and pre-teens have very different developmental needs, abilities, and risk tolerances, and expecting them to safely and effectively use the same set of structures is unrealistic. Younger children may feel overwhelmed or unsafe around bigger, faster, more physically capable kids, while older children often feel restricted when they have to share equipment that is not challenging enough for their age. This overlap can lead to avoidable accidents, frustration for parents, and a diminished experience for all age groups. I strongly encourage the City to look into playground models used in other communities that intentionally separate or "zone" play areas based on developmental stages. A great example is the Tunnel Tops park in San Francisco. Their Outpost Playground features distinct areas that gradually increase in challenge, allowing toddlers, younger children, and older kids to each have play experiences suited to their abilities. Many other neighborhood parks in San Francisco also follow this model, with clear separation between toddler areas, early childhood play structures, and more advanced climbing or adventure elements for older children. This type of design: -Enhances safety by reducing collisions and mismatched play styles -Supports children's developmental needs more intentionally -Gives older kids opportunities for meaningful, age-appropriate physical challenges - Helps caregivers supervise more effectively -Creates a more inclusive and enjoyable environment for families I believe Birmingham could greatly benefit from adopting a similar approach in future park renovations or new park plans. Thoughtfully zoning playgrounds acknowledges the diverse needs of our community's children and ensures that all age groups can play confidently, safely, and joyfully

maviolassi

12/09/2025 07:11 PM

Concept 1 needs more regular swings and more slides. Whenever we are at the park, kids congregate to all the slides and swings. Sandbox

needed.

hollyschwan

12/10/2025 05:26 AM

I am hopeful that most if not all of the existing trees will remain. They provide additional shaded areas and a great ambiance in the park.

ryanclarkdoyle

12/10/2025 10:41 AM

More benches for parents. Sandbox.

jingxu.zhan

12/10/2025 11:22 AM

Concept 1 has too less slide, Concept 2 has too many slides. Can we do a fusion? Overall Concept 1 seems cover more age, and the Burgundy color match the environment better.

tdery

12/10/2025 11:43 AM

Concept one, need more swings.

DougA

12/10/2025 03:53 PM

I think you are missing the mark on both concepts. The park is large and expansive for a reason. I realize there is a budget. What this feels like is that you are building the Park around a budget; instead of designing the Park and then creating a budget. If either design is selected I feel that it will be less of a Park and the end to charm of Pembroke Park as we know and love it! I watched (driving by) the building of the Park off Lincoln St. That is a smaller park and seems nice. But, one concept does not fit all. From what I understand, one of the concept goals is address the drainage issue. Condensing the park into an concrete enclosed "basin" filled in with wood chips may solve the drainage issue but forces playground to be smaller. Which is a mistake. Not having the diverse swing sets is a mistake. Keep the same number and type of swing sets Condensing the play area is a mistake Not sure why a shade structure is needed. This is a 90% shaded playground. The structure is not needed Both designs miss the mark! Go back to the drawing board.

Sarahelsea

12/11/2025 06:09 AM

Making it more age inclusive. There's not great easy access for small kids to climb up.

Fdiem6

12/17/2025 03:52 AM

More swings and a swing that has 4 and spins in a circle. A royal oak park has one and it's a huge hit for kids! More swings like we have and baby swings. The swings are always full at the park!

MegaJams

12/17/2025 12:41 PM

Yes, more swings. Concept 1 only has 1 regular swings, concept 2 has none.

acorrell

12/17/2025 12:59 PM

Bathroom (probably not feasible) and drinking fountain

mkrajenke

12/17/2025 01:24 PM

Large, shaded area for pregnant mothers or the elderly to sit in the shade to watch children.

annelipp

12/17/2025 02:32 PM

More swings, put the zip line in too!

Madison St

12/17/2025 07:23 PM

Water fountains, permanent tables w/benches.

MaryM

12/19/2025 09:34 AM

more benches and shaded areas for adults / seniors

Janet

12/19/2025 08:30 PM

Concept 2 needs swings. One adaptive swing is not enough. Sandboxes are missing in both concepts. Add baby swings and possibly a small playhouse/structure for 0-2 age group.

iladomer

12/24/2025 09:19 AM

Outdoor squash court. See Accesscourts. Com

MZ12

12/25/2025 04:35 PM

Gated enclosure

Erin_genesis

12/26/2025 04:56 AM

Can't view them

me.loveridge

12/28/2025 01:35 PM

I think there should be more swings on Concept 1 for both younger (baby/toddler) kids and older kids. It looks like Concept 2 doesn't even have swings. There are a lot of kids within the Pembroke park area and they always like to swing. Swings are important in any concept. A saucer swing or a spinning stand alone element is also always a hit. So are seesaw elements.

Plaidrick

12/30/2025 01:37 PM

It is both audacious and profoundly insulting to solicit "glow up" feedback from a neighborhood that you have systematically ignored for decades. While the city identifies creative ways to gild the lily in neighborhoods already flush with green space, you continue to collect tax dollars from the only neighborhood in Birmingham that does not

have a park of its own. Your request for input on "concepts" reveals a staggering lack of awareness regarding the following: Taxation Without Recreation: Residents in this neighborhood pay the same premium property taxes as those in Quarton Lake, Poppleton Park, or Pembroke. Yet, year after year, our tax dollars are diverted to "upgrade" existing amenities for others while we are left with zero municipal footprint in our own backyard. The Irony of a "Glow Up": To propose aesthetic enhancements for neighborhoods that already have 10s, while our neighborhood sits at a 0, is the definition of fiscal and civic negligence. A "glow up" is a luxury; basic neighborhood access to a park is a fundamental service that this city is failing to provide. Systemic Exclusion: This is not an oversight; it is a choice. By focusing on the "polishing" of existing parks rather than the acquisition of land or the development of green space in the city's only "park desert," you are codifying a tiered system of residency. Our feedback is simple: Cease the performative surveys regarding bench styles and playground color palettes for the "haves" until you have a concrete, funded plan to provide a park for the "have-nots." Stop asking us how you should decorate other people's backyards with our money. Until this neighborhood is represented on the city's park map, any "glow up" initiative is nothing more than a monument to the city's departmental favoritism and lack of vision.

Parsimon3

12/30/2025 01:50 PM

Benches and seating for caregivers and places for strollers

Sarah V

12/30/2025 01:58 PM

Shaded elements

stephanie.tong

12/30/2025 03:36 PM

I hope the trees stay! They are not a part of the concept drawings. If the trees need to be removed to produce either concept, I'd vote to keep our existing play areas AND our trees. The current play structures are just fine and should not be taken out if the trees need to be sacrificed to do so

DJO

12/30/2025 03:43 PM

Noted only 2 benches. Parents would like to sit while watching their children play.

avhughes1

12/30/2025 04:03 PM

Shade and benches for adults in a few different spots. As a mother of 4 and a grandmother of 8 I have found there are never places to sit in the shade.

Onedogmama

More trees and nature. What I love about this park is the variety of

12/30/2025 04:03 PM

different areas and the big trees.

Margaret Murray

12/30/2025 05:21 PM

Nature-based elements and adventure elements have a much longer shelf life than traditional playground structures because they are open ended and appeal to older children as well.

KimberleyCrew

12/30/2025 06:51 PM

Shaded area should have full view of playground without blindspots.

ND

12/30/2025 07:20 PM

We like the fun elements like the little house in concept 2. More stuff like that would be fun, bring in some natural elements would be really nice.

Pemfam

12/30/2025 07:35 PM

A cool place for tweens to hang bc they still want to be at the playground but just not in a babyish way...maybe hammocks they could lay and read in or a cool tree house element.

LFallert

12/30/2025 08:53 PM

Baby bucket swings, basketball courts

North Eton

12/31/2025 04:45 AM

Trees to shade the area Parking on North Eton for the safety of the children in the play area....speeding on North Eton is a problem

Sdwise57

12/31/2025 05:35 AM

A renewed basketball court

Heidi G.

12/31/2025 06:58 AM

Please plant more trees!

db

12/31/2025 07:15 AM

Water fountain

SDSchutte

12/31/2025 08:50 AM

no

tginnebaugh

12/31/2025 09:57 AM

Shade structures over the kids play areas!! Essential in the summer when the structures become too hot to use Tire swing My kids love the accessible spinner at Innovation Hills

dplipp

12/31/2025 10:00 AM

I appreciate the variety of activities and ages they are geared towards in concept 2. I believe this is a good balance considering the current neighborhood use. However I think the shade structure/picnic area should be scratched in favor of retaining swings on the periphery of the central playground. Add a screen of small arbor vitae behind the musical instruments to absorb some of the sound before it reaches the surrounding neighbors.

spoonscar

12/31/2025 10:34 AM

More shaded/seating areas.

birminghamliver

12/31/2025 12:24 PM

KEEP THE TREES! All the new playgrounds cut down the wildlife, this is not okay. Also, inclusion does not require all the rope items. I've been to the parks with ropes, as a nanny, these are very difficult even for myself. Nature elements are important. The park is also good as of now but would benefit for a few more play spaces and to leave the open field. This is what makes this park so good!

Yaxie

12/31/2025 02:55 PM

Plants and natural landscaping

Bham1

12/31/2025 03:21 PM

More regular swings, unless I missed them? Would love the natural elements mentioned as a choice in the ratings. A small (not large picnic) shaded area(s) with seating would be nice.

Sharon Saad

12/31/2025 10:42 PM

A paved path for riding bikes, walking, running or roller blading around the entire park.

thanthese

1/01/2026 05:32 AM

I don't see much height or older kids.

Alice

1/01/2026 07:06 AM

Yes. Shade on the playground equipment is missing in concept 1. There must be shade over the playground equipment not just the picnic areas. Concept 2 has nice shade over playground areas however seems geared mostly for kids up to 7 or 8 as the slides and all equipment looks low. Most large playscapes we see around the country and internationally have nice sweeping awnings over the play areas and Birmingham lacks far behind in this area. Kids and parents need shade for playground days.

MaryOlah

1/01/2026 07:53 AM

More "traditional " swings including "baby bucket" type swings. Having used this play ground for over 30 years, swings by far have been the

most highly used parts, for various age groups.

purduemark

1/01/2026 01:19 PM

climbing wall

Renee

1/02/2026 06:37 AM

Monkey bars would be a great addition and more swings. I would like to see the trees remain and not cut them down to build a new structure. Can you work around them?

mdleduc

1/02/2026 08:25 AM

not enough swings!

Dorchester

1/02/2026 01:31 PM

Adult exercise stations. Pull-up bar for adult.

Jessica Heid

1/02/2026 07:40 PM

Both concepts are short on swings. Baby swings were such a fond memory at this park when my kids were little. It would be a shame to lose that. Climbing structures are a must.

Optional question (72 response(s), 41 skipped)

Question type: Essay Question

Q9 | Are there any suggestions or comments you would like to share about the future Pembroke Park Playground?

Kfrei1

12/05/2025 09:28 AM

This park gets muddy fast. The main structure with the multiple slides at the northwest corner of the park needs to be elevated and properly drained. There's a good month in April/May when it rains several days in a row and then you can't use the park for a month because it's just so waterlogged. Like to reiterate more sidewalks around the park and into key areas for ease of strollers and so kids can learn to ride their bikes in a safe space.

kobrien18

12/05/2025 09:29 AM

We highly value the trees, shade, and natural integrity of the park. Recognizing that these are concept photos and may not reflect the park beyond the playground elements - it would be preferred that these updates not come at the expense of the trees and natural feel. We would also prefer prioritizing simple and engaging playground elements over pavilions and group seating features.

Nina Bernardi

12/06/2025 04:05 AM

Leaving the trees (that create so much shade) and space to run. Please don't touch the sandboxes! If anything, make the sandboxes larger! They are a staple at our park. Please leave the ground as grass! People come and picnic with blankets and we don't need a seating area. The picnic tables are moved as needed and work perfectly! As someone who lives in Pembroke area, I love how natural our park is with the canopy trees and open ground. Frequenting daily by my house, I witness kids play in the grassy space, spend hours in the sandboxes, and create adventures on the structures. I thoroughly enjoy that there are two distinct play structures, one focused on little kids, another geared towards more adventurous or older kids. And they are separate spaces (so you don't have a 12 yr old climbing next to a 2 yr old who is figuring out how to climb). Please take these things into consideration. Pembroke Park is a staple as is.

cwojew

12/08/2025 07:44 AM

I don't think there needs to be a shade canopy unless you plan to take out all the trees that are there - this park is already nearly 100% shaded.

Trina0522

12/08/2025 09:13 AM

Thank you all for working hard to make this possible.

Maple

12/08/2025 04:36 PM

Toilets are important.

CMSO

12/08/2025 04:44 PM

I believe having clean and accessible bathrooms is a must for parents of small children. It will allow parents to enjoy the park for longer without having to rush off if bathroom breaks or other bathroom related needs arise.

AnnaWhittier

12/08/2025 04:49 PM

We are excited.

smcclain

12/08/2025 05:33 PM

An indoor building with a bathroom that would be open at certain times of day/weekends would be amazing! Any type of water feature would be popular in summer!

debimarques

12/08/2025 05:46 PM

I would love if it also had bathrooms. Also would love if a pet area were to be added.

Mellos4

12/08/2025 06:45 PM

We would spend more time at the park with any of these improvements.

Spartymom68

12/08/2025 06:45 PM

Make sure to keep benches around the perimeter of the park, a drinking fountain or two. Plenty of trash receptacles and picnic benches. Maybe build more tennis courts or pickleball courts?

Jaimezavier

12/08/2025 11:07 PM

It would be wonderful to have sidewalk/walking path through the park for strollers

Ebwelch

12/09/2025 05:55 AM

Please keep as many trees as possible, we love the natural shade. The recent Adams park does not have enough shade.

Korrie926

12/09/2025 06:28 AM

Please make friendly for all ages.

Lizmkauf

12/09/2025 12:03 PM

What equipment meets code or could meet code that is already there ? The question needs to be addressed before the park design can be properly answered .

Patrickdery

12/09/2025 06:20 PM

I'd like to keep as much of the existing structures

Pembroke Resident

12/09/2025 06:35 PM

NO BATHROOMS! NO PAVILION! NO UNNATURAL SHADING!
More play structures the better.

Michael Dery

12/09/2025 06:43 PM

Pembroke Park is a neighborhood park - it isn't a city park or special use park as outlined in the Birmingham Parks and Rec assessment published in 2023. It doesn't need a bathroom, a pavilion, or shaded area. It is designed to serve the citizens located Pembroke Manor - not visitors or the greater city of Birmingham for that matter.

Emileedecker

12/09/2025 07:10 PM

I do not support adding bathrooms to this park. Because it's meant for neighborhood use, restrooms would draw more non-local traffic and could lead to maintenance issues or unwanted activity. I also don't believe a pavilion is necessary for a small neighborhood park. Larger structures can attract gatherings beyond the park's intended use and may invite noise, litter, or misuse. Finally, I would like more information on the City's long-term maintenance plan and budget. Any added features require ongoing upkeep, and understanding how the City plans to manage this is important for evaluating what is appropriate for the space.

maviolassi

12/09/2025 07:11 PM

I believe people are missing the point of what a “neighborhood park” is. This specific park is to serve this specific neighborhood’s needs first. There should be no shaded area for people to congregate at as there are so many trees anyways that I do not see a need for a shaded area when those trees offer way more than enough shade. I am not a fan of how condensed these structures are. All the kids love running around and I don’t see why we are designing this park around accommodating parents when this park is for kids. Unfortunately, I will miss how spread out the original park is as I think it’s important to not have all the structures so close together when so many kids are using them at once.

ryanclarkdoyle

12/10/2025 10:41 AM

I have lived facing the slide of Pembroke park for 5 years and we appreciate the spread out options all over the park. I hope this is an upgrade to central area but that does not mean the peripheral activity areas go away. We also hope the nature and tree cover will be preserved. The shade and natural elements are as valuable as the actual play structures.

jingxu.zhan

12/10/2025 11:22 AM

Maybe few speed bumps on roads near by the playground make us parents feel safer.

tdery

12/10/2025 11:43 AM

The existing swings, both the baby swings and the larger swings are not in the footprint of the new structure and SHOULD stay. Also the existing structure not in the drawing should also stay, it’s great for the kids today.

DougA

12/10/2025 03:53 PM

Match the current layout of Pembroke Park in a new concept drawing.

Aadhmi

12/12/2025 06:13 PM

Needs Zipline, tunnels, shaded sandbox, bathroom

Fdiem6

12/17/2025 03:52 AM

More swings with the great design of the new structure. Restrooms especially since soccer games are played there a lot and the shaded area with picnic tables. We have a big beautiful park but the shaded area and restrooms would be a major plus

MegaJams

12/17/2025 12:41 PM

Keep regular swings! Teens and adults also enjoy these

acorrell

12/17/2025 12:59 PM

As a neighbor with grown kids I walk around the park often but don't really use the playground so I can't comment on the correct equipment. Seems like it's mostly younger kids and often siblings of older kids using the park for baseball or soccer. Having something nicer than a port-a-potty would be great and some sort of cover for shade or rain would be helpful. It is used frequently so it would be nice if it was refreshed.

mkrajenke

12/17/2025 01:24 PM

I would like to see ADA compliant equipment and ADA accessible equipment.

annelipp

12/17/2025 02:32 PM

Appreciate the idea of consolidating the play spaces but there is still enough space for the swings and zip line without taking away from the structures. Love the little play house for the 2-5 age set; I think pretend play is so important and often neglected at outdoor facilities.

Madison St

12/17/2025 07:23 PM

The basketball court at Adams Park is very busy all the time with players of all ages. A new basketball court at Pembroke Park would be very popular. Sidewalks around the entire perimeter of the park would be nice.

MJWoolfield

12/18/2025 06:47 AM

A bit off topic but any chance you could look at upgrading the basketball setup at Pembroke Park? There are a lot of older kids who really enjoy this element of the park but it could use an upgrade. Otherwise we love the park and it is a great community facility. Thanks, Mike

Janet

12/19/2025 08:30 PM

We have 8 grandchildren between the ages of 1-6 years old who use this park weekly. The current park is a wonderful mix of activities. The two current play structures are great because toddlers have one area while older kids use the other. The kids love running from one activity to the next. There is a lot of separation between play areas making every activity special and independent of the others. These new concepts aren't unique, Every school in the area has a playground like these proposed concepts. Including Derby Elementary right down the road. The kids love this park because it is different. The sandboxes and the bouncy animals and big slide will be missed.

Erin_genesis

12/26/2025 04:56 AM

Better shade for parents mor sitting cleaner environment

me.loveridge

12/28/2025 01:35 PM

It feels like the two concepts are aimed at different ages vs. including all. Concept 1 feels like it is aimed for elementary aged children with more difficult climbing structures with ropes to walk between. It has similar items to Pembroke Elementary School. Concept 2 feels aimed for toddler/young preschool aged kids (less climbing, easier play structures, small house, music instruments, no swings). It would be great if the chosen concept could include elements of both so children in both age ranges had elements that would appeal to all ages. Lots of families have households with toddlers and elementary aged kids & it would be nice to have a park that appeals to all. I do like the musical instruments in concept 2.

Jstodd

12/30/2025 01:28 PM

I like how the current park has swings and play areas that are appropriate for younger and older children. I'd like to see that in the future playground. I would love to see a bathroom as opposed to the porta potty that is used in the spring/summer. I also hope the picnic tables stay as my family uses them regularly. I prefer the current grass as opposed to any synthetic materials used for the surface.

Plaidrick

12/30/2025 01:37 PM

It is both audacious and profoundly insulting to solicit "glow up" feedback from a neighborhood that you have systematically ignored for decades. While the city identifies creative ways to gild the lily in neighborhoods already flush with green space, you continue to collect tax dollars from the only neighborhood in Birmingham that does not have a park of its own. Your request for input on "concepts" reveals a staggering lack of awareness regarding the following: Taxation Without Recreation: Residents in this neighborhood pay the same premium property taxes as those in Quarton Lake, Poppleton Park, or Pembroke. Yet, year after year, our tax dollars are diverted to "upgrade" existing amenities for others while we are left with zero municipal footprint in our own backyard. The Irony of a "Glow Up": To propose aesthetic enhancements for neighborhoods that already have 10s, while our neighborhood sits at a 0, is the definition of fiscal and civic negligence. A "glow up" is a luxury; basic neighborhood access to a park is a fundamental service that this city is failing to provide. Systemic Exclusion: This is not an oversight; it is a choice. By focusing on the "polishing" of existing parks rather than the acquisition of land or the development of green space in the city's only "park desert," you are codifying a tiered system of residency. Our feedback is simple: Cease the performative surveys regarding bench styles and playground color palettes for the "haves" until you have a concrete, funded plan to provide a park for the "have-nots." Stop asking us how you should decorate other people's backyards with our money. Until this neighborhood is represented on the city's park map, any "glow up" initiative is nothing more than a monument to the city's departmental favoritism and lack of vision.

Parsimon3

12/30/2025 01:50 PM

Consider the caregivers and make it caregiver friendly. Add a walking path, parks should not be only about the kids and play structures

stephanie.tong

12/30/2025 03:36 PM

Please keep the trees! We've lost so many mature trees in our neighborhood lately—please keep as many as possible. Do not update the park at the expense of trees...

DJO

12/30/2025 03:43 PM

Hopefully there are areas outside the "Play" area with benches so older (seniors can sit and read a book or eat lunch. Shade areas would be nice.

Onedogmama

12/30/2025 04:03 PM

What about Kenning park? It needs attention. This park is also a short walk from Pembroke school playground.

Margaret Murray

12/30/2025 05:21 PM

Water management in the spring is a major issue, as muddy puddles and soaked grass is common,

KimberleyCrew

12/30/2025 06:51 PM

Enough seating at multiple points around the playground. Limit blindspots from these seating areas.

ND

12/30/2025 07:20 PM

Shady areas to sit would be excellent

Pemfam

12/30/2025 07:35 PM

A small area for dogs to play?

LFallert

12/30/2025 08:53 PM

Where is placement of structure? Where is the large grouping of trees being planted? How large is the area? More swings. I am concerned about having all the structures in one area. Our families with special needs children/adults, without physical disabilities, need to be able to be on the playground at the same time as young children. Having all of the play areas grouped together makes this more difficult.

Detroitrealist

12/30/2025 10:08 PM

No enclosed structures or permanent rest rooms should be added. They are nothing but a huge security risk. Its difficult to tell from the drawings, but both plans look really "cramped". Why does the selection box for concept 1 indicate a "burgundy" foundation when it clearly shows a green base?

Sdwise57

12/31/2025 05:35 AM

Renew the basketball court

Heidi G.

12/31/2025 06:58 AM

Like Poppleton Park, Pembroke Park is in the middle of a thriving neighborhood and Parking around the park needs to also be addressed. For the children's and neighbors safety, parking should only be allowed on one side of the street. This is standard in the city of Troy and I don't understand why Birmingham doesn't utilize this concept throughout it's neighborhoods. It is better for visibility(kids crossing the street to the playground), and allows school busses sand emergency vehicles to get through.

SDSchutte

12/31/2025 08:50 AM

Basketball "court" could be better

dplipp

12/31/2025 10:00 AM

I would like to understand views of the maintenance staff of the parks department relating to the sandbox. How difficult is this to clean/maintain, and do they conduct any testing or monitoring for bacteria levels? Stick with red and yellow to align with Pembroke Elementary's school colors.

birminghamliver

12/31/2025 12:24 PM

Keep the trees. Add nature elements. More inclusive for the bigger playground, more ramps, more swings. Toys for bigger kids . More picnic tables.

Yaxie

12/31/2025 02:55 PM

The grass between the current play areas is nice for running around. I'd prefer for the ground to be more natural than rubber.

megan.spearin

12/31/2025 05:31 PM

Please add bathrooms!

Sharon Saad

12/31/2025 10:42 PM

I have lived in this neighborhood 25 years and raised 4 kids here. People love this park because it has grass and not hard surfaces. They also like it because of the shade. Too many modern parks are blistering hot because of no shade. This particular park tends to hold water after rain. It makes it quite soggy. I would like to see that change. Another concept I really like is a mini water stream going through it like the one at Innovation hills. Paved crevice for water to pass through for kid to play in. With the size of this park it would be a good use of space for a paved path around the perimeter for walking, running, roller blading, skateboarding or kids riding bikes. More picnic tables and or park benches.

thanthese

1/01/2026 05:32 AM

1. I'd like to see pickleball lines added to the tennis courts. 2. We need a trashcan at the main park entrance/exit. 3. The park has the best trees/shade of any park in the city, in my opinion. It is essential to me that that is preserved.

Alice

1/01/2026 07:06 AM

See above. Thank you.

MaryOlah

1/01/2026 07:53 AM

Possibly greater separation between the various elements. It appears crammed together.. Maybe separate toddlers from older children.

purduemark

1/01/2026 01:19 PM

would be good to benchmark other parks in birmingham for popular features, like the slide hill and bridge in Booth Park, etc

ahb96

1/02/2026 05:34 AM

Add a pickle ball court

Dorchester

1/02/2026 01:31 PM

Need adult exercise stations. Pull up bar for adults. Look at other outdoor parks with adult exercise stations.

Jessica Heid

1/02/2026 07:40 PM

Pembroke park is one of the most, if not the most, activated parks in the Birmingham. I honestly love the park the way it is. I love how the play equipment is spread out and kids run to each area. I love that picnic tables are dispersed so families can have some privacy and they can be grouped together for parties. There can be two parties on opposite sides. The trees are my absolute favorite and it would be a shame if any were cut down to make the new design happen.

linda1878

1/04/2026 10:56 AM

Please no musical things - drums, xylophone, etc. The park is surrounded by houses and many people (myself) go to the park to enjoy the green space and peace and quiet. I don't mind the sound of kids playing, but please don't add in drums and other additional noisemakers! I liked concept 2 because it looks less frenetic and junky. Also the one swing where the kids can ride it along a rail was super popular with the kids at another park I visited. I actually was ready to push my way into line so I could ride it, too!

Optional question (64 response(s), 49 skipped)

Question type: Essay Question









Playground

2-12



The play components identified on this plan are IPEMA certified. (Unless model number is preceded with *) The use and layout of these components conform to the requirements of ASTM F1487. To verify product certification, visit www.ipema.org

THIS PLAY AREA & PLAY EQUIPMENT IS DESIGNED FOR AGES 2-12 YEARS UNLESS OTHERWISE NOTED ON PLAN.

IT IS THE MANUFACTURERS OPINION THAT THIS PLAY AREA DOES CONFORM TO THE A.D.A. ACCESSIBILITY STANDARDS, ASSUMING AN ACCESSIBLE PROTECTIVE SURFACING IS PROVIDED, AS INDICATED, OR WITHIN THE ENTIRE USE ZONE.

THIS CONCEPTUAL PLAN WAS BASED ON INFORMATION AVAILABLE TO US. PRIOR TO CONSTRUCTION, DETAILED SITE INFORMATION INCLUDING SITE DIMENSIONS, TOPOGRAPHY EXISTING UTILITIES, SOIL CONDITIONS, AND DRAINAGE SOLUTIONS SHOULD BE OBTAINED, EVALUATED, & UTILIZED IN THE FINAL DESIGN. PLEASE VERIFY ALL DIMENSIONS OF PLAY AREA, SIZE, ORIENTATION, AND LOCATION OF ALL EXISTING UTILITIES, EQUIPMENT, AND SITE FURNISHINGS PRIOR TO ORDERING. SLIDES SHOULD NOT FACE THE HOT AFTERNOON SUN.

CHOOSE A PROTECTIVE SURFACING MATERIAL THAT HAS A CRITICAL HEIGHT VALUE TO MEET THE MAXIMUM FALL HEIGHT FOR THE EQUIPMENT (REF. ASTM F1487 STANDARD CONSUMER SAFETY PERFORMANCE SPECIFICATION FOR PLAYGROUND EQUIPMENT FOR PUBLIC USE, SECTION 8 CURRENT REVISION). THE SUBSURFACE MUST BE WELL DRAINED. IF THE SOIL DOES NOT DRAIN NATURALLY IT MUST BE TILED OR SLOPED 1/8" TO 1/4" PER FOOT TO A STORM SEWER OR A "TRENCH DRAIN".

ACCESSIBLE/PROTECTIVE SURFACING TO BE A COMBINATION OF UNITARY AND LOOSE FILL MATERIALS.
 EWF: 3,142 SF, PIP: 5,212 SF, SAND: 161 SF

DESIGNED BY:

AH

COPYRIGHT: 1/17/2026
 LANDSCAPE STRUCTURES, INC.
 601 7th STREET SOUTH - P.O. BOX 198
 DELANO, MINNESOTA 55328
 PH: 1-800-328-0035 FAX: 1-763-972-6091

Date	Previous Drawing #	Initials

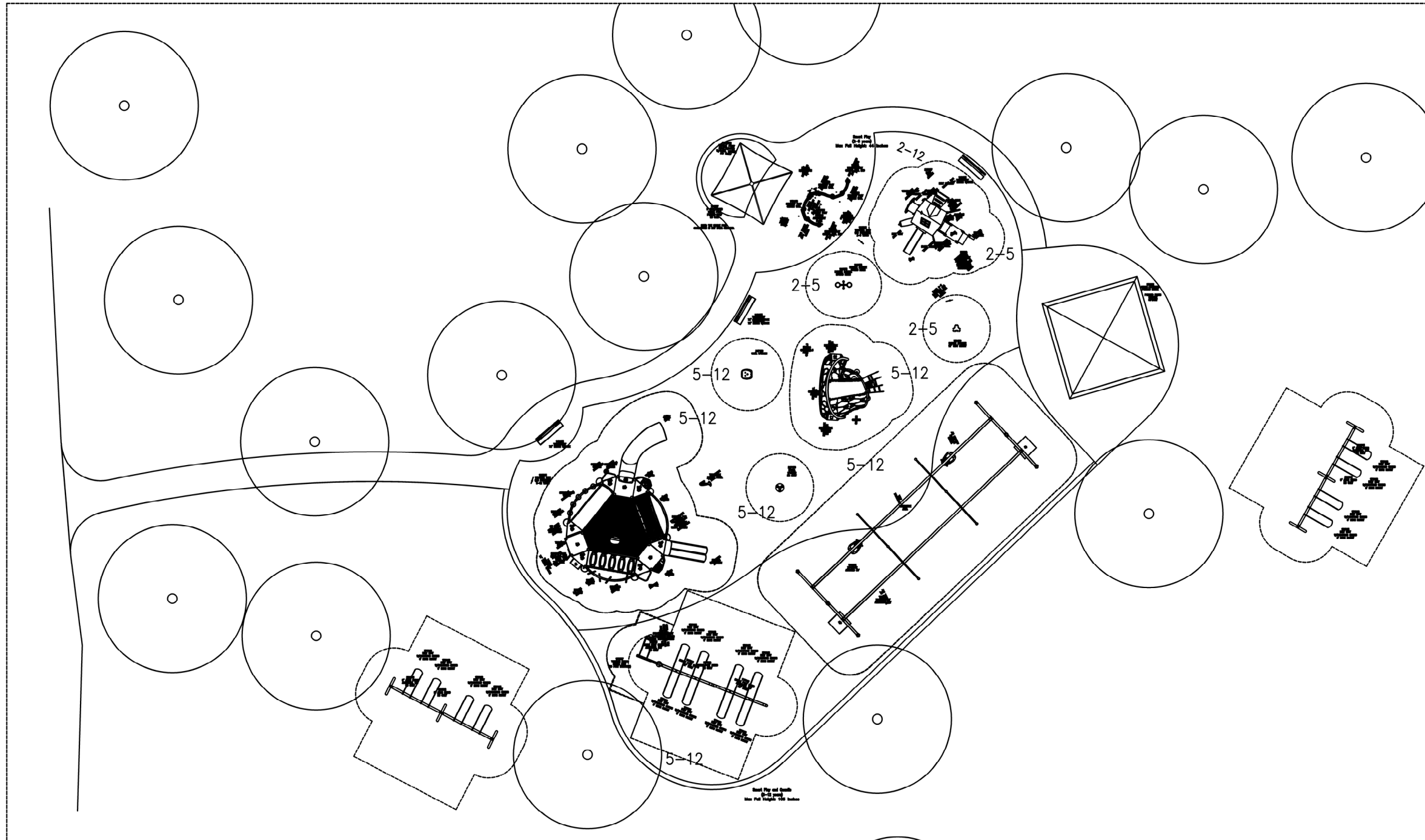

5-12 AREA

TOTAL ELEVATED PLAY COMPONENTS	15		
TOTAL ELEVATED COMPONENTS ACCESSIBLE BY RAMP	0	REQUIRED	0
TOTAL ELEVATED COMPONENTS ACCESSIBLE BY TRANSFER	12	REQUIRED	8
TOTAL ACCESSIBLE GROUND LEVEL COMPONENTS SHOWN	15	REQUIRED	4
TOTAL DIFFERENT TYPES OF GROUND LEVEL COMPONENTS	10	REQUIRED	10

2-5 AREA

TOTAL ELEVATED PLAY COMPONENTS	5		
TOTAL ELEVATED COMPONENTS ACCESSIBLE BY RAMP	0	REQUIRED	0
TOTAL ELEVATED COMPONENTS ACCESSIBLE BY TRANSFER	5	REQUIRED	3
TOTAL ACCESSIBLE GROUND LEVEL COMPONENTS SHOWN	12	REQUIRED	2
TOTAL DIFFERENT TYPES OF GROUND LEVEL COMPONENTS	10	REQUIRED	10



Pembroke Park
 Birmingham, MI

Penchura, LLC
 Lance Shipman

SYSTEM TYPE:
 Quantis/Smart Play
 DRAWING #:
 PEN1202880-03





LS landscape
structures

Pembroke Park

Top Down • 2.1.2026





LS landscape structures

Pembroke Park

PEN1202880-03 • 1.28.2026



© 2026 Landscape Structures. All Rights Reserved





landscape
structures

Pembroke Park

PEN1202880-03 • 1.28.2026



© 2026 Landscape Structures. All Rights Reserved



landscape
structures

Pembroke Park

PEN1202880-03 • 1.28.2026



© 2026 Landscape Structures. All Rights Reserved



landscape
structures

Pembroke Park

PEN1202880-03 • 1.28.2026



© 2026 Landscape Structures. All Rights Reserved







LS landscape structures

Pembroke Park

PEN1202880-03 • 1.28.2026





landscape
structures

Pembroke Park

PEN1202880-03 • 1.28.2026







PROJECT: _____
 LOCATION: _____
 BUILDING TYPE: SQR-20
 ROOF TYPE: MULTI-RIB
 BUILDING NUMBER: _____
 ORDER NUMBER: _____
 QUOTE NUMBER: _____

DRAWING LIST:

SHEET NUMBER	DRAWING DESCRIPTION
CS	COVER SHEET
1	ARCHITECTURAL ELEVATIONS
2	STRUCTURAL FRAMING PLAN
3	COLUMN LAYOUT



CERTIFICATES:

MIAMI-DADE COUNTY CERTIFICATE OF COMPETENCY NO. 21-0819.13
 PCI (POWDER COATING INSTITUTE) 4000 CERTIFIED

FABRICATOR APPROVALS:

CITY OF PHOENIX, AZ APPROVED FABRICATOR #C08-2010
 CITY OF LOS ANGELES, CA APPROVED FABRICATOR #FB01596
 CITY OF RIVERSIDE, CA APPROVED FABRICATOR #SF_000042
 CITY OF HOUSTON, TX APPROVED FABRICATOR #470
 CLARK COUNTY, NV APPROVED FABRICATOR #264
 STATE OF UTAH APPROVED FABRICATOR 02008-14
 AISC APPROVED FABRICATOR C-00018751

MATERIALS:

DESCRIPTION	ASTM DESIGNATION
TUBE STEEL	A500 (GRADE B)
SCHEDULE PIPE	A53 (GRADE B)
RMT PIPE	A519
LIGHT GAGE COLD FORMED	A1003 (GRADE 50)
STRUCTURAL STEEL PLATE	A36
ROOF PANELS (STEEL)	A653



GENERAL NOTES:

UNLESS NOTED OTHERWISE, THIS STRUCTURE WAS DESIGNED TO ONLY SUPPORT WHAT IS SHOWN ON THESE DRAWINGS. THE MANUFACTURER MUST BE CONTACTED IF ANYTHING ELSE IS TO BE ATTACHED TO THIS STRUCTURE (WALLS, COLUMN WRAPS, RAILINGS, ETC.) SO THE DESIGN OF THIS STRUCTURE CAN BE REVIEWED AND POSSIBLY REVISED.

UNLESS NOTED OTHERWISE, THIS STRUCTURE WAS DESIGNED ASSUMING A 20' SEPARATION BETWEEN ANY ADJACENT STRUCTURE WITH AN EAVE HEIGHT EQUAL TO OR GREATER THAN THE EAVE HEIGHT OF THIS STRUCTURE. IF THAT SEPARATION DOES NOT EXIST, THE MANUFACTURER MUST BE CONTACTED SO THE DESIGN OF THIS STRUCTURE CAN BE REVIEWED AND POSSIBLY REVISED.

STRUCTURAL STEEL SHALL BE DETAILED, FABRICATED, AND ERECTED IN ACCORDANCE WITH THE LATEST EDITION OF THE AMERICAN INSTITUTE OF STEEL CONSTRUCTION (AISC) SPECIFICATION MANUAL.

ALL WELDING IS PERFORMED BY AMERICAN WELDING SOCIETY (AWS) CERTIFIED WELDERS AND CONFORMS TO THE LATEST EDITION OF AWS D1.1 OR D1.3 AS REQUIRED.

PARTS SHOWN MAY BE UPGRADED DUE TO STANDARDIZED FABRICATION. REFER TO THE SHIPPING BILL OF MATERIALS FOR POSSIBLE SUBSTITUTIONS.

FOR PROPER FIELD INSTALLATION OF THE BUILDING IT IS RECOMMENDED THAT THE PRIMARY FRAME INSTALLER AND THE ROOF INSTALLER HAVE A MINIMUM FIVE (5) YEARS DOCUMENTED EXPERIENCE INSTALLING THIS TYPE OF PRODUCT.

FOR PROPER FIELD INSTALLATION OF THE BUILDING IT IS RECOMMENDED THAT ELECTRIC WIRING, IF REQUIRED, BE RUN THROUGH THE STRUCTURAL MEMBERS BEFORE THE BUILDING IS ERECTED.

STOP!!
NOT FOR CONSTRUCTION
 USE FOR PRELIMINARY
 PLANNING AND ESTIMATING
 ONLY

poligon
 by PORTER CORP
 WWW.POLIGON.COM
 MAIN: (616) 888-3500
 FIELD SUPPORT: (616) 888-3504

REV LEVEL:	A	SCALE:	1:48
DRAWN BY:	chris.lisac	PRINT DATE:	12/28/2023
		JOB NO.:	
		CAD MODEL:	SQR-20
PROJECT:		PROJECT LOCATION:	
		DRAWING:	COVER SHEET
		SHEET	CS

GENERAL ROOF NOTES:

1. METAL ROOFING:
 - 24 GAUGE
 - GALVALUME COATED
 - KYNAR 500 PAINTED
2. TRIM COLOR MATCHES ROOF
3. SEE POLIGON.COM FOR COLOR OPTIONS

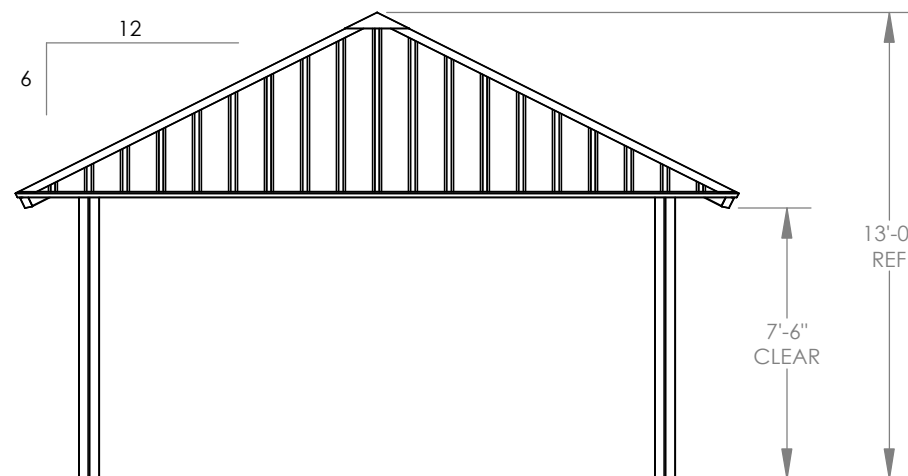
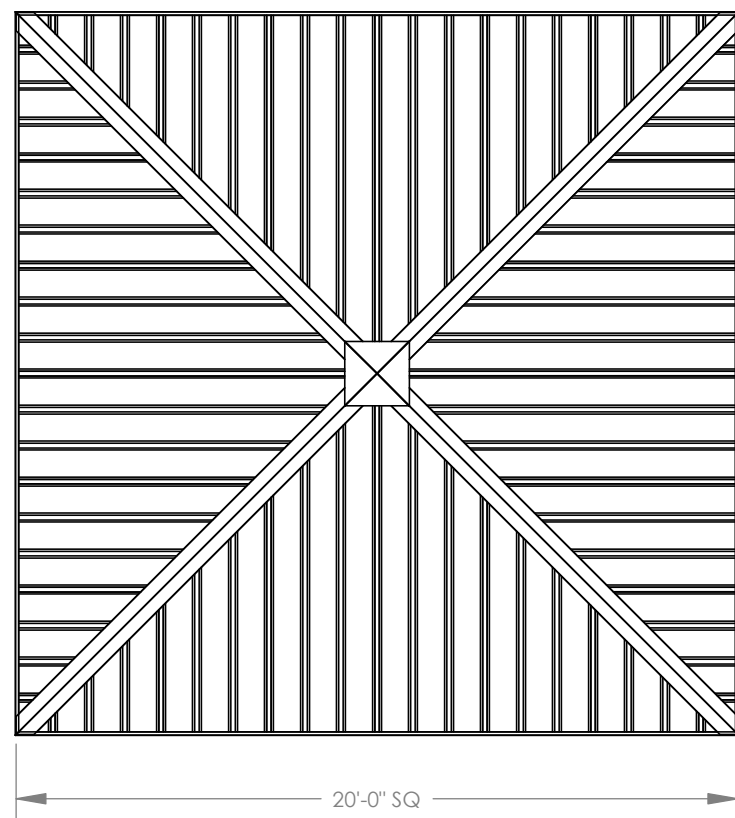

FINISH GRADE.
MOUNTING VARIES
BASED ON ENGINEERING
REQUIREMENTS.

STOP!!
NOT FOR CONSTRUCTION

USE FOR PRELIMINARY
PLANNING AND ESTIMATING
ONLY

DRAWING: ARCHITECTURAL ELEVATIONS	
SCALE: 1:64	REV LEVEL: A
poligon [®] by PORTERCORP	(616)399-1963 www.poligon.com
<small>COPYRIGHT 2016 PATENTED OR PATENTS PENDING PORTERCORP 4240 N. 136th AVE HOLLAND, MI 49424</small>	SHEET 1

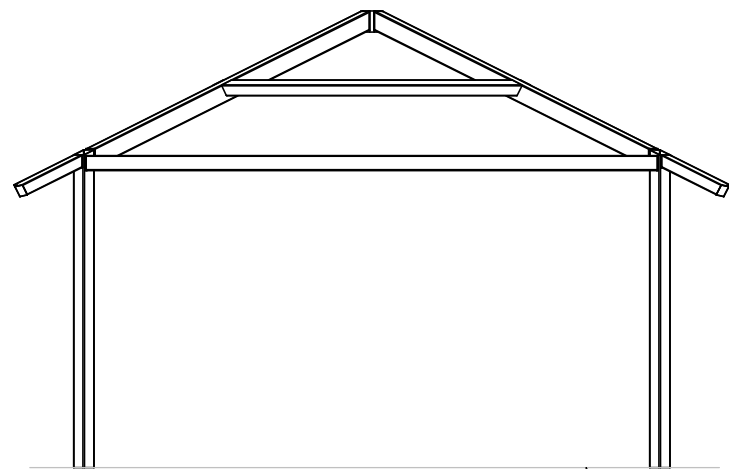
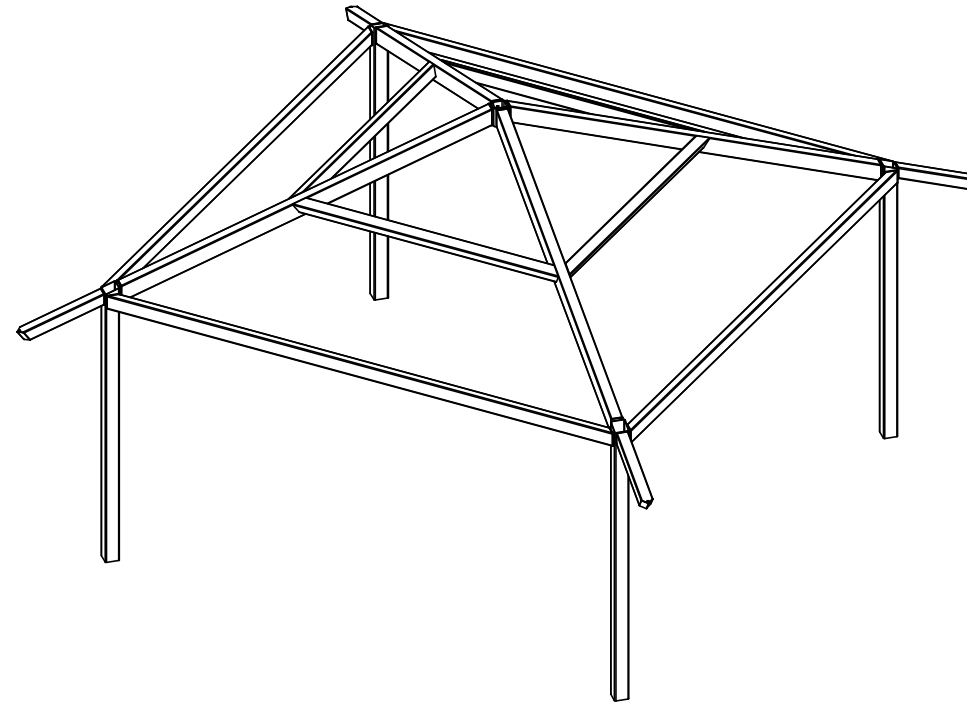
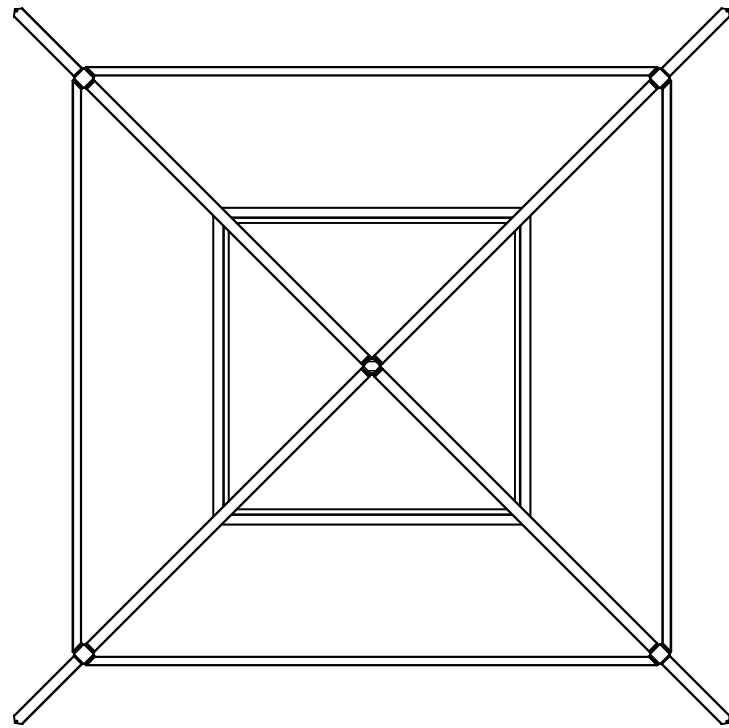

FINISH GRADE.
MOUNTING VARIES
BASED ON ENGINEERING
REQUIREMENTS.

STOP!!
NOT FOR CONSTRUCTION
USE FOR PRELIMINARY
PLANNING AND ESTIMATING
ONLY

DRAWING: STRUCTURAL FRAMING PLAN	
SCALE: 1:64	REV LEVEL: A
<p>poligon[®] (616)399-1963 www.poligon.com by PORTERCORP</p> <p><small>COPYRIGHT 2016 PATENTED OR PATENTS PENDING PORTERCORP 4240 N. 136th AVE HOLLAND, MI 49424</small></p>	
SHEET 2	

BASEPLATE NOTES:

- 1. POLIGON ENGINEERING WILL DETERMINE REQUIRED BASEPLATE DESIGN AFTER ENGINEERING PACKAGE IS ORDERED.
- 2. CUSTOMER MAY SUGGEST PREFERRED BASEPLATE DESIGN.

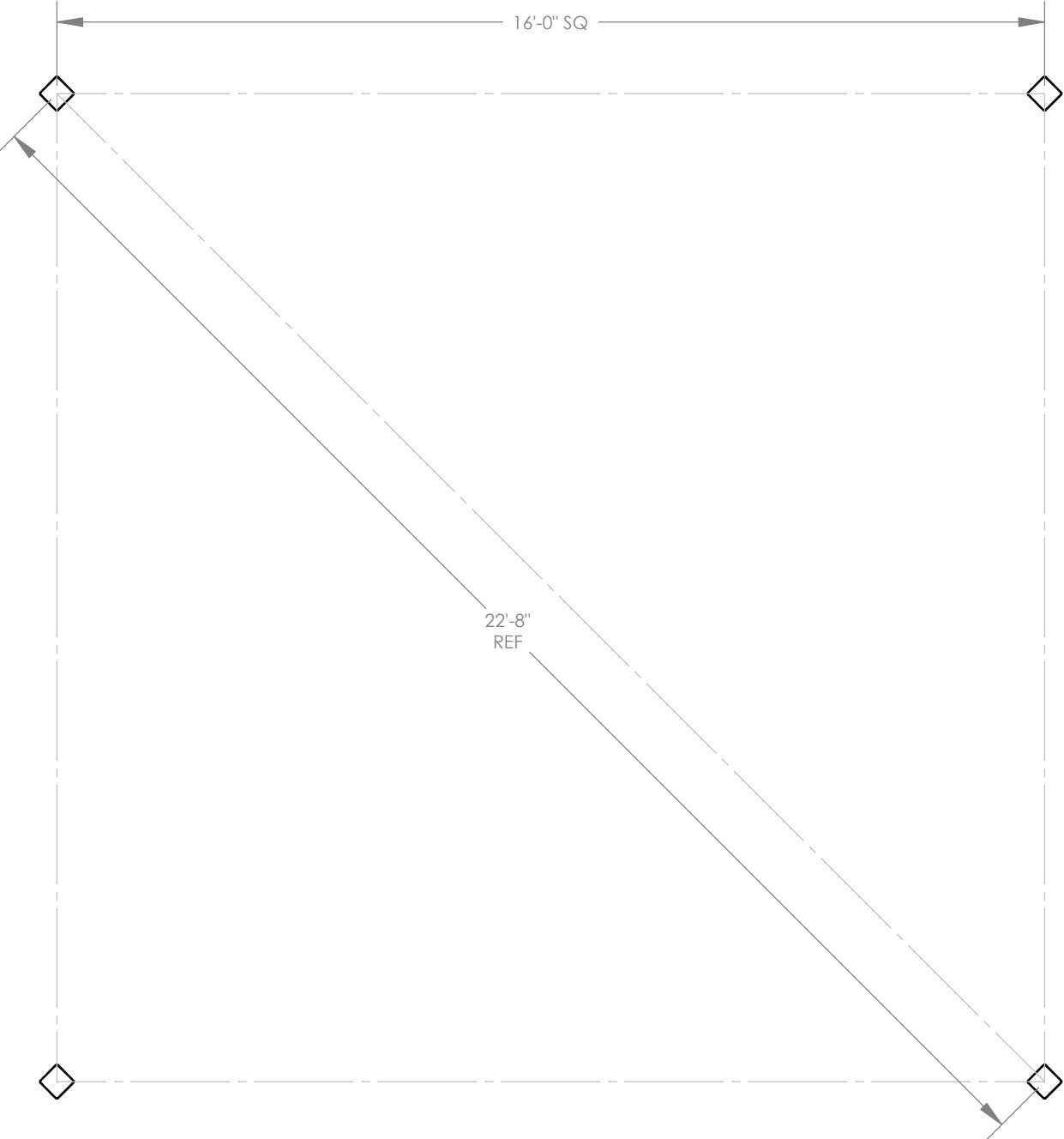

STOP!!
NOT FOR CONSTRUCTION
USE FOR PRELIMINARY
PLANNING AND ESTIMATING
ONLY

DRAWING: COLUMN LAYOUT		REV LEVEL: A
SCALE: 1:32		
poligon [®] by PORTERCORP		(616)399-1963 www.poligon.com
<small>COPYRIGHT 2016 PATENTED OR PATENTS PENDING PORTERCORP 4240 N. 136th AVE HOLLAND, MI 49424</small>		SHEET 3



FRAME COLOR: SURREY BEIGE
ROOF COLOR: EVERGREEN
COLORS SHOWN FOR ILLUSTRATIVE PURPOSES ONLY. FOR OTHER
COLOR SELECTIONS, PLEASE SUBMIT AN E1 DRAWING REQUEST.



Please make check payable to:
Landscape Structures Inc
 601 7th Street S
 Delano, MN 55328

Proposal

Date	Proposal #
1/26/2026	26-136

Bill To:
City of Birmingham P.O. Box 3001 151 Martin Street Birmingham, MI 48012-3001

Ship To
City of Birmingham Brad McNab, 248-514-8902 851 S. Eton Birmingham, MI 48009

Customer Contact	Customer Phone	Customer Fax	Terms	P.O. No.	Rep
Brad McNab	248-514-8902	248-530-1754	Net 30		LAS

Item	Description	Qty	Weight	Price	Total
	Pembroke Park LSI equipment with Sourcewell				
323659A	Volo Play Structure, DB	1		89,530.50	89,530.50
322404A	Quantis A.3	1		39,494.40	39,494.40
247189A	Chill Spinner	1		2,932.50	2,932.50
247179A	Curva Spinner	1		2,682.60	2,682.60
195507B	ZipKrooz, 50' With Steel Post, Additional Bay	1		19,354.50	19,354.50
196212B	ZipKrooz™ Assisted 50' Aluminum Posts	1		19,385.50	19,385.50
182503C	Welcome Sign Ages 5-12 Direct Bury	1		0.00	0.00
174018A	Belt Seat w/Chains ProGuard Chains for 8' Beam Height	4		178.50	714.00
176038G	Full Bucket Seat w/ProGuard Chains for Toddler Swing	1		494.70	494.70
177332A	Single Post Swing Frame 8' Beam Height	1		1,744.20	1,744.20
177333A	Single Post Swing Frame Additional 8' Bay	1		1,295.40	1,295.40
177337A	Toddler Swing Add-On Beam	1		719.10	719.10
223857A	Smart Play®: Loft 2-5 Direct Bury	1		24,995.10	24,995.10
164075B	Double Bobble Rider, Direct Bury, Yello	1		2,963.10	2,963.10
152179A	Saddle Spinner	1		1,009.80	1,009.80
Misc	Sensory Wall	1		15,988.50	15,988.50
154397A	LSI Single Post Cool Topper	1		5,650.80	5,650.80
182503A	Welcome Sign Ages 2-5 years Direct Bury			0.00	0.00
141683A	TT Coated Bench 72" w/Back Direct Bury (121 lbs)	2		882.30	1,764.60
Freight	Freight			6,000.00	6,000.00

Proposal Good For 30 Days
 Shipping Time: TBD
 Ship Via: Common Carrier
 Please call 24 hours prior to delivery: _____

Customer signature below constitutes a purchase order.

Subtotal
Sales Tax (0.0%)
Total

Penchura, LLC, 889 S. Old US 23 Brighton, MI 48114
 Office: (810) 229-6245 Fax: (810) 229-6256 Toll Free: (888) 778-7529



Please make check payable to:
Landscape Structures Inc
 601 7th Street S
 Delano, MN 55328

Proposal

Date	Proposal #
1/26/2026	26-136

Bill To:
City of Birmingham P.O. Box 3001 151 Martin Street Birmingham, MI 48012-3001

Ship To
City of Birmingham Brad McNab, 248-514-8902 851 S. Eton Birmingham, MI 48009

Customer Contact	Customer Phone	Customer Fax	Terms	P.O. No.	Rep
Brad McNab	248-514-8902	248-530-1754	Net 30		LAS

Item	Description	Qty	Weight	Price	Total
Sourcewell D...	Sourcewell Discount			-18,457.54	-18,457.54

Proposal Good For 30 Days
 Shipping Time: TBD
 Ship Via: Common Carrier
 Please call 24 hours prior to delivery: _____

Customer signature below constitutes a purchase order.

Subtotal	\$218,261.76
Sales Tax (0.0%)	\$0.00
Total	\$218,261.76

Penchura, LLC, 889 S. Old US 23 Brighton, MI 48114
 Office: (810) 229-6245 Fax: (810) 229-6256 Toll Free: (888) 778-7529



Make all P.O.s, Contracts, and Checks to:
Penchura, L.L.C.
889 S. Old US 23
Brighton, MI 48114

Proposal

Date	Project #
1/26/2026	26-136-2

Bill To
City of Birmingham P.O. Box 3001 151 Martin Street Birmingham, MI 48012-3001

Ship To
City of Birmingham Brad McNab, 248-514-8902 851 S. Eton Birmingham, MI 48009

Customer Contact	Customer Phone	Customer Fax	Terms	P.O. No.	Rep
Brad McNab	248-514-8902	248-530-1754	Net 30		LAS

Item	Description	Qty	Weight	Price	Total
Demolition	Pembroke Park Installation - Estimated Demolition (including temp fencing around work site, play equipment, EWF, 58'x4' concrete access walk, drinking fountain pad)	1		43,000.00	43,000.00
Excavate	Playground Excavation and backfilling old playground areas w/ onsite spoils	1		20,437.50	20,437.50
Installation	Concrete - Estimated	1		61,125.00	61,125.00
Stone Base	Supply and Install crushed stone base and prep for PIP Installation	1		18,750.00	18,750.00
Installation	Install Playground equipment, benches, single post cool topper, sandbox sand	1		92,375.00	92,375.00
Installation	Install new drinking fountain in same location as old one and provide 4'x4' concrete pad . Does not include water tap or service line - Estimated	1		3,750.00	3,750.00
Installation	Restoration of all areas disturbed due to construction with topsoil, hydroseed	1		19,750.00	19,750.00
PIP - Install	PIP - Install & Supplied - Safety Surfacing	5,211		23.00	119,853.00
EWF-I	Engineered Wood Fiber -Supplied & Installed - Safety Surfacing	145		43.75	6,343.75
	Note: The removal and/or salvaging or reinstalling of any site amenities is not included.				

Proposal good for 30 days.
 Ship Via: common carrier
 Delivery contact name and number: _____

Customer signature below constitutes a purchase order.

Subtotal
Sales Tax (0.0%)
Total

Credit Card fee of 3% on all payments using a CC.
AMX fee of 5% on all payments using AMX

889 S. Old US 23, Brighton, MI 48114
 Office: (810) 229-6245 Fax: (810) 229-6256 Toll Free: (888) 778-7529



Make all P.O.s, Contracts, and Checks to:
Penchura, L.L.C.
 889 S. Old US 23
 Brighton, MI 48114

Proposal

Date	Project #
1/26/2026	26-136-2

Bill To
City of Birmingham P.O. Box 3001 151 Martin Street Birmingham, MI 48012-3001

Ship To
City of Birmingham Brad McNab, 248-514-8902 851 S. Eton Birmingham, MI 48009

Customer Contact	Customer Phone	Customer Fax	Terms	P.O. No.	Rep
Brad McNab	248-514-8902	248-530-1754	Net 30		LAS

Item	Description	Qty	Weight	Price	Total
	Assumes any drinking fountain, swing bench, park benches and receptacles are provided by others.				

Proposal good for 30 days.
 Ship Via: common carrier
 Delivery contact name and number: _____

Customer signature below constitutes a purchase order.

Subtotal	\$385,384.25
Sales Tax (0.0%)	\$0.00
Total	\$385,384.25

Credit Card fee of 3% on all payments using a CC.
AMX fee of 5% on all payments using AMX

889 S. Old US 23, Brighton, MI 48114
 Office: (810) 229-6245 Fax: (810) 229-6256 Toll Free: (888) 778-7529



Make all P.O.s, Contracts, and Checks to:
Penchura, L.L.C.
889 S. Old US 23
Brighton, MI 48114

Proposal

Date	Project #
1/26/2026	26-136-1

Bill To
City of Birmingham P.O. Box 3001 151 Martin Street Birmingham, MI 48012-3001

Ship To
City of Birmingham Brad McNab, 248-514-8902 851 S. Eton Birmingham, MI 48009

Customer Contact	Customer Phone	Customer Fax	Terms	P.O. No.	Rep
Brad McNab	248-514-8902	248-530-1754	Net 30		LAS

Item	Description	Qty	Weight	Price	Total
Poligon	Pembroke Park Shade with Sourcewell Poligon 20 ft. Square Stained Tongue & Groove Multi-Rib			28,510.00	28,510.00
Poligon	Poligon Electrical Access Electrical Cutouts Anchor Bolt Kit			730.00	730.00
Poligon	Engineering			625.00	625.00
Freight	Freight			1,875.00	1,875.00
Sourcewell Dis...	Sourcewell Poligon Discount - Poligon Structure			-2,339.20	-2,339.20
Installation	Professional Certified Installation			31,578.95	31,578.95
Sourcewell Dis...	Sourcewell Discount - Installation			-1,578.95	-1,578.95

Proposal good for 30 days.
Ship Via: common carrier
Delivery contact name and number: _____

Customer signature below constitutes a purchase order.

Subtotal	\$59,400.80
Sales Tax (0.0%)	\$0.00
Total	\$59,400.80

Credit Card fee of 3% on all payments using a CC.
AMX fee of 5% on all payments using AMX

889 S. Old US 23, Brighton, MI 48114
Office: (810) 229-6245 Fax: (810) 229-6256 Toll Free: (888) 778-7529